

GEDORE

TOOLS FOR LIFE

Hydraulic Drive Set



KL-0039-800 K

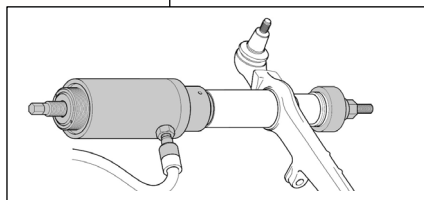
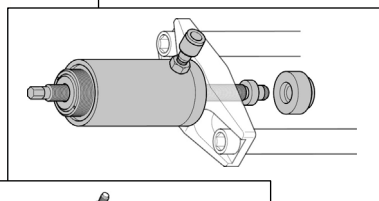
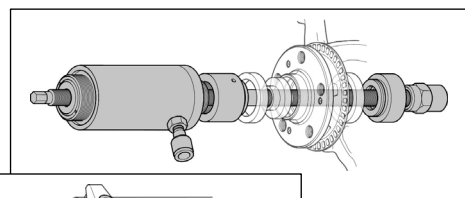

KL-0039-800K_EN250202.docx

GEDORE Automotive GmbH

Breslauer Straße 41
78166 Donaueschingen

Postfach 1329
78154 Donaueschingen - GERMANY

Phone: +49 (0) 771 / 8 32 23-0
Fax: +49 (0) 771 / 8 32 23-90

Email: info@gedore-automotive.com
Internet: www.gedore-automotive.com

KL-0039-800 K



Scope of delivery: KL-0039-800 K

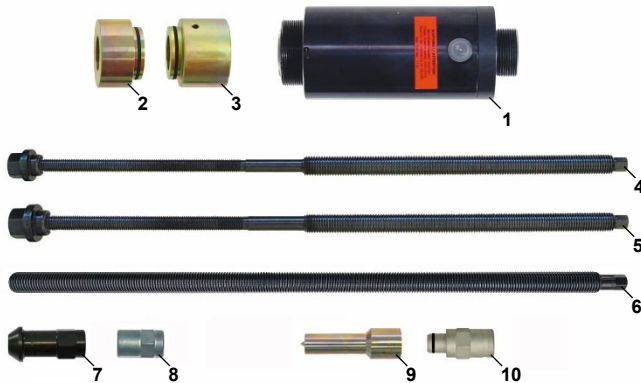

Example of use:

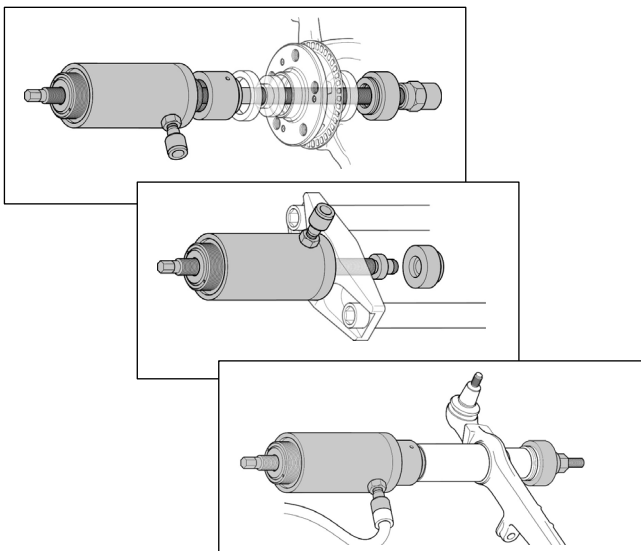

KL-0039-800 K Hydraulic Drive Set

Field of Application

Designed to complement our mechanical tool sets such as the pulling device for silentbloc **KL-0039-412 K**, **KL-0039-413 K**, wheel bearing tool set **KL-0039-0110 K** or puller series **KL-0174-...** so as to enable them to be driven by the hydraulic cylinder 17 t **KL-0040-2500**.

Due to its special design as a tubular piston cylinder and thanks to the possibility to be used in conjunction with various spindles, the hydraulic cylinder **KL-0040-2500** is suitable for pulling and pushing operations. Even severely seized bearings, bushes or drive shafts can be removed and installed quickly and easily by using this 17t drive kit.

Technical Data

Max. load capacity of the pull spindle M12: 7 t

Max. load capacity of the pull spindle M14: 9 t

Max. load capacity of the pull spindle M20: 20 t

Max. load capacity of the pressure spindle M20: 20 t

Max. load capacity of the hydraulic cylinder: 17 t

Warnings and Notes

- Any work on vehicles should only be performed by qualified personnel observing and complying with the directions, provisions, and safety regulations issued by the vehicle manufacturer.
- Only the vehicle manufacturer's data apply to all work done on the vehicle.
- Working with hydraulic tools calls for specific safety precautions to be observed.
- Before putting the tool into operation, visually check that it is not damaged.

It is imperative to observe the following points:

- Never strike the tool with a hammer!

Scope of delivery

Pos.	Part No.	Description	Qty.
	KL-0039-800 K	Hydraulic Drive Set	1
consists of:			
1	KL-0040-2500	Hydraulic cylinder 17 t	1
2	KL-0039-1002	Retainer adaptor for clamping nut and pressure spindle	1
3	KL-0039-1003	Retainer adaptor for hydraulic cylinder	1
4	KL-0039-1912	Pull spindle M12, with nut	1
5	KL-0039-1914	Pull spindle M14, with nut	1
6	KL-0039-1920-1 A	Pull spindle M20	1
7	KL-0039-1920-4	Clamping nut Ø 38mm	1
8	KL-0040-3009	Clamping nut	1
9	KL-0039-1935	Press piece	1
10	KL-0041-5041	Clamping nut with insert	1
-	KL-0039-8009	Plastic storage case	1