



# SERVICE BOOK

MOUNTING INSTRUCTION OF CONNECTORS

SERVICE MOUNTING INSTRUCTION ASPÖCK SYSTEMS SERVICE MOUNTING INSTRUCTION ASPÖCK SYSTEMS SERVICE MOUNTING INSTRUCTION ASPÖCK SYSTEMS







# LIST OF CONTENTS

	Page	
Symbol legend	4	
DC-System (double click)	10	
P&R-System (press & ready)	12	
Bayonet	2 pin	14
	5 pin	18
	8 pin	22
	15 pin	28
ASS1, ASS2	2 pin	32
ASS1, ASS2, ASS2.1	7 pin	36
ASS3	3 pin	40
	17 pin	44
AMP	4 pin	48
	7 pin	52
SuperSeal	2 pin	56
	3 pin	60
	4 pin	64
	6 pin	68
DEUTSCH connector	2 pin	72
	4 pin	76
	6 pin	80
Standard connector	8 pin	82
	12 pin	82
Caravan connector	16 pin	84
ISO 1185	7 pin	85
ISO 3731	7 pin	85
ISO 12098	13 pin	86
	15 pin	87
ISO 1724	7 pin	88
ISO 11446	8 pin	89
	13 pin	89
DIN 9680	3 pin	90
VBG	14 pin	91

# SYMBOL LEGEND

Symbol					
	Masse	Earth	massa	Masse	Masa
	Blinker links	LH rear direction indicator	freccia sinistra	Clignotant gauche	Intermitente izquierdo
	Blinker rechts	RH rear direction indicator	freccia destra	Clignotant droit	Intermitente derecho
	Bremslicht	stop	stop	Feu stop	Luz de freno
	Standlicht links	LH Tail	posizione sinistra	Feu de position gauche	Luz posición izquierda
	Standlicht rechts	RH Tail	posizione destra	Feu de position droit	Luz posición derecha
	Nebelschlussleuchte	rear fog	retronebbia	Feu de brouillard	Luz antiniebla
	Rückfahrleuchte	reverse	retromarcia	Feu de recul	Luz marcha atrás
	All. Stromversorgung (+)	permanent power supply	positivo permanente	Alimentation électrique permanente (+)	corriente continua
	Achsanhhebung	axle lift	Sollevatore	Relevage d'essieu	dispositivo de elevación del eje
	Federspeicheranzeige	braking control	Controllo funzioamento freni	Contrôle freinage remorque	Control de frenos para trailers
	Verschleißanzeige	brake pad wear Indicator	Controllo usura pastiglie	Témoin d'usure des plaquettes de frein	Indicador de desgaste de las pastillas de freno
	Masse für Elektroniken	Earth - Data	Massa per elettronica	Masse des éléments électroniques	masa funciones electrónicas
	freie Wahl	unallocated	libero	Libre	Libre elección

# SYMBOL LEGEND

					Symbol
Terra	Massa	Jord	jord	maa	
Pisca esquerdo	knipperlicht Links	Venstre blinklys	blinker vänster	vilkku vasen	
Pisca direito	knipperlicht Rechts	Høyre blinklys	blinker höger	vilkku oikea	
Freio	Rem licht	Bremselys	bromsljus	jarruvalo	
Luz de posição esquerda	Achterlamp Links	Venstre parklys	parkljus vänster	parkki vasen	
Luz de posição direita	Achterlamp Rechts	Høyre parklys	parkljus höger	parkki oikea	
Luz de neblina	Mist lamp	Tåkelys	dimljus	sumuvalo	
Luz de Ré	Achteruitrij lamp	Baklys	backljus	peruutusvalo	
corrente contínua	Constante stroomverzorging	Allmenn strømforsyning	allmän strömförsörjning	jatkuva virta	
dispositivo de elevação do eixo	Aslift	Akselløft	axellyft	akselinosto	
Controle de funcionamento dos freios	Remcilinder markering	Bremseindikator	bromsindikator	jousijarrun ilmaisin	
Indicador de desgaste de pastilhas de freio	Remslijtage indicator	Slitasjeindikator	slitageindikator	jarrujen kulumisen ilmaisin	
Terra para funções eletrônicas	Massa Data	Jord for elektronikk	jord för elektronik	elektroniikan maa	
Livre	Vrije positie	Fritt valg	fritt val	vapaa	

# SYMBOL LEGEND

Symbol					
	Mass	Masa	Masa	маса	масса
	Vasak suunatuli	Kreisais pagrieziens	Lewy Kierunkowskaz	лівий поворотник	левый поворотник
	Parem suunatuli	Labais pagrieziens	Prawy Kierunkowskaz	правий поворотник	правый поворотник
	Pidurituli	Stop signāls	Światło Stop	стоп-сигнал	стоп-сигнал
	Vasak tagatuli	Kreisais gabariņš	Lewa Pozycja	ліве габаритне світло	левый габаритный свет
	Parem tagatuli	Labais gabariņš	Prawa Pozycja	праве габаритне світло	правый габаритный свет
	Udutuli	Miglas lukturis	Światło Przeciwmgłowe	протиотуманный ліхтар	протиотуманный фонарь
	Tagurdustuli	Atpakaļgaitas lukturis	Światło Cofania	ліхтар заднього ходу	фонарь заднего хода
	Pidev toide	Pastāvīgs spriegums	Stale Zasilanie	постійна напруга	постоянное напряжение питания
	Telje tōste	Paceļamais tilts	Podnoszenie Osi	підйомна вісь	подъёмная ось
	Pidurduskontroll	Bremžu kontrole	Kontrola Hamowania	керування гальмуванням	управление торможением
	Piduriklotside kulumise indikaator	Bremžu noduluma sensors	Wskaźnik Zużycia Okładzin Hamulcowych	датчик зносу гальмівних колодок	датчик износа тормозных колодок
	Infokaabli mass	Masa- Dati	Masa Elektroniki	маса електроніки	масса электроники
	Vaba	Brīvais	Wolny	вільний	свободный

# SYMBOL LEGEND

					Symbol
Uzemnění	Uzemnenie	Földelés	masa, ozemljitev	Masa, uzemljenje	
Blinkr levá strana	Smerovka lavá strana	Index, bal	smerokaz levi	Lijevi žmigavac	
Blinkr pravá strana	Smerovka pravá strana	Index, jobb	smerokaz desni	Desni žmigavac	
Brzdové světlo	Brzdové svetlo	Féklámpa	stop luč	Štop svijetlo	
Parkovací světlo levé	Parkovacie svetlo lavé	Helyzetjelző, bal	leva pozicijska luč	Lijevo poziciono svijetlo	
Parkovací světlo pravé	Parkovacie svetlo pravé	Helyzetjelző, jobb	desna pozicijska luč	Desno poziciono svijetlo	
Mlhovka	Hmlové svetlo	Ködlámpa	meglenka	Maglenka	
Zpáteční světlo	Svetlo spiatocky	Tolatólámpa	luč vzvratne vožnje	Rikverc svijetlo	
Stálý elektrický proud	Stály elektrický prud	Töltés	napajanje	Napajanje	
Zdvihnutí nápravy	Zdvihnutie nápravy	Tengelyemelés	dvig osi	Podizač osovine	
Kontrola brzdy	Kontrola brzdy	Fékvisszajelző	kontrola zavor	Kontrola kočnica	
Indikátor opotřeбенí	Indikátor opotrebenia	Fékkopás jelző	indikator obrabe zavor	Indikator potrošnje kočnica	
Uzemnění elektroniky	Uzemnenie elektroniky	Elektr. Földelés	ozemljitev za elektroniko	Uzemljenje za elektroniku	
Volné	Volné	Szabad	odklenjeno	Otključano	

# SYMBOL LEGEND

Symbol				
	Masa, uzemljenje	Masa, uzemljenje	Masa (impamintare)	заземление
	Lijevi žmigavac	Levi žmigavac	indicator semnalizare stanga	ляв мигач
	Desni žmigavac	Desni žmigavac	indicator semnalizare dreapta	десен мигач
	Štop svijetlo	Štop svetlo	STOP	стоп сингал
	Lijevo poziciono svijetlo	Levo poziciono svetlo	lampa pozitie stanga	габарит ляв
	Desno poziciono svijetlo	Desno poziciono svetlo	lampa pozitie dreapta	габарит десен
	Maglenka	Maglenka	lampa ceata	светлина задна за мъгла
	Rikverc svijetlo	Rikverc svetlo	lampa marsarier	светлини задна скорост
	Napajanje	Napajanje	Alimentare electrica permanenta	постоянно напрежение
	Podizač osovine	Podizač osovine	axa liftanta	повдигане оси
	Kontrola kočnica	Kontrola kočnica	control sistem franare	ръчна спирачка
	Indikator potrošnje kočnica	Indikator potrošnje kočnica	Indicator uzura placate frana	износване на накладките
	Uzemljenje za elektroniku	Uzemljenje za elektroniku	Masa	електроника заземление
	Otključano	Otključano	Liber	свободно



# SYMBOL LEGEND

				Symbol
Şase, toprak	ارت	الارضى	הארקה	
Sinyal, sol	راهنما چپ	المؤشر الخلفى لاتجاه اليمين	איתות שמאל	
Sinyal, sağ	راهنما راست	المؤشر الخلفى لاتجاه اليسار	איתות ימין	
Fren	چراغ ترمز	توقف	اور بلم	
Park, sol	چراغ توقف چپ	ضوء الذيل اليسار	חניה שמאל	
Park, sağ	چراغ توقف راست	ضوء الذيل اليمين	חניה ימין	
Arka sis	چراغ مه شکن عقب	مزيل الضباب الخلفى	اور عرفل	
Geri vites	چراغ دنده عقب	اشارة المسير الى الخف	اور نسیעה لاخور/روورس	
Sürekli enerji	منبع تغذیه دائمی	امدادات الطاقة دائم - كان ۲۴	הזנה קבועה	
Dingil kaldırma	بالابر محور	رفع المحور	חיווי הרמת סרן	
Treyler EBS	کنترل ترمز	اشارة التحكم بالوقوف	חיווי בלם חניה	
Balata aşınma	نشانگر سایش لنت	اشارة انتهاء صلاحية الكوابح	חיווי בלאי רפידה	
Şase, elektronik	ارت براي الكترونيك	بيانات الارضى	הארקה אלקטרוניקה	
Serbest hat	انتخاب آزاد	حالة عدم الربط(حره)	פנוי	

# Double Click System - mounting instruction

DC  
System

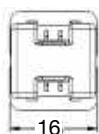
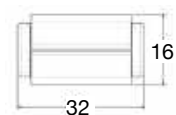

$I_{max}=5A$

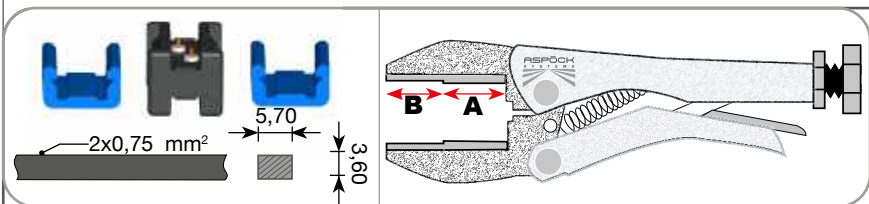
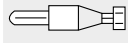

1.



2.



3.

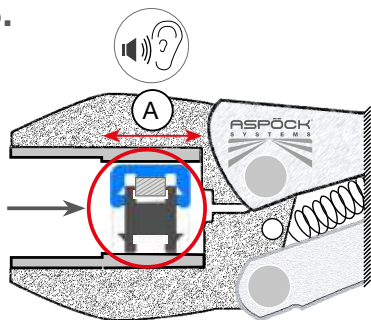

4.

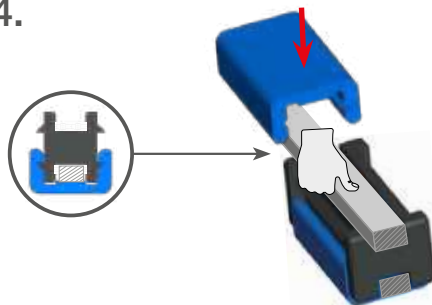

5.

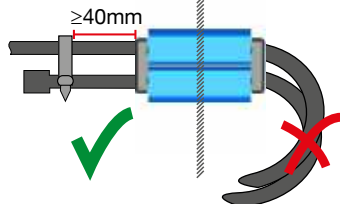
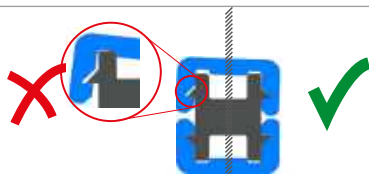
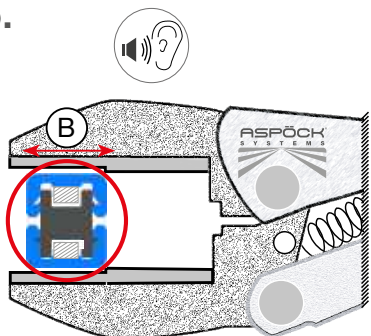

# Double Click System - repair instruction

DC  
System

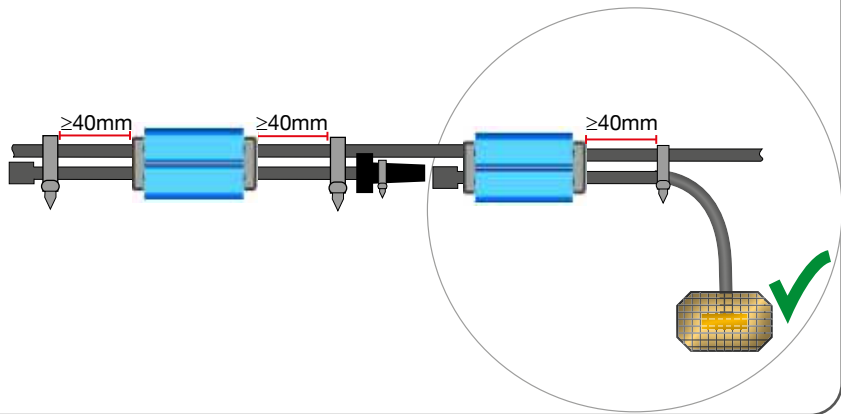
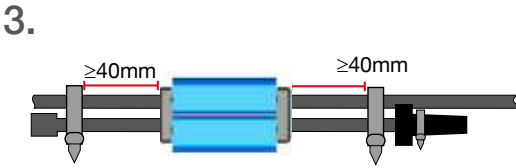
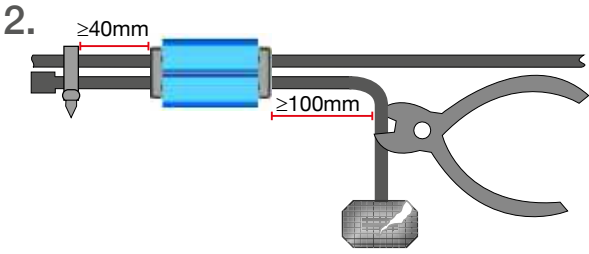
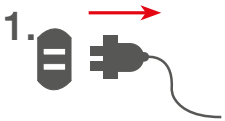
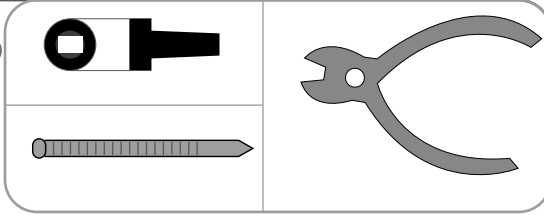
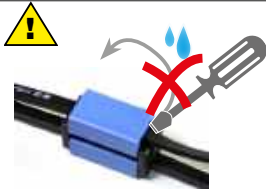

P&R  
System

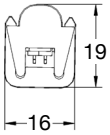
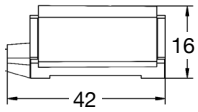
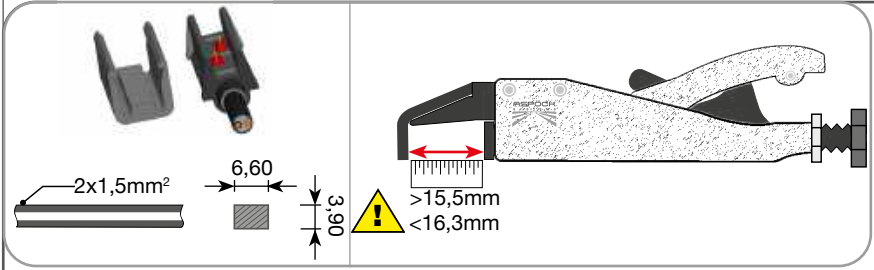

1.



2.



3.

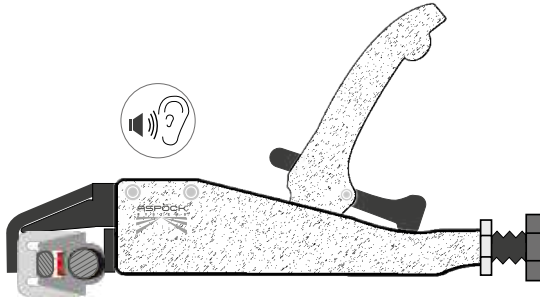

$I_{max}=8A$

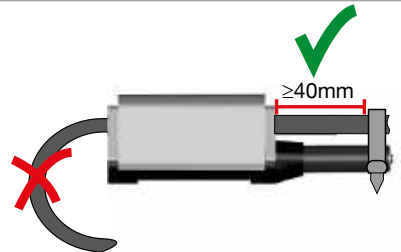
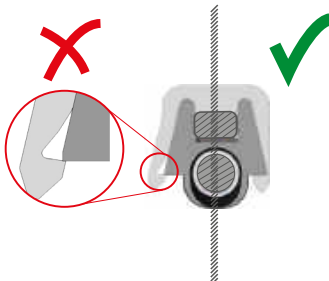
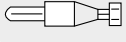

# Press and Ready System - repair instruction

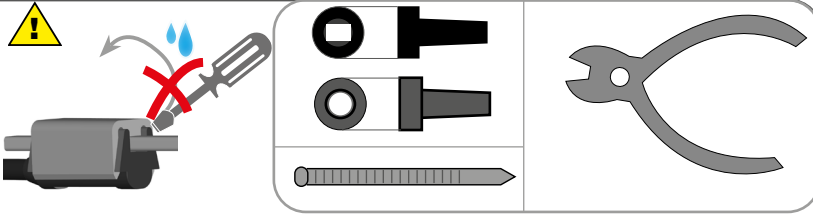

1.

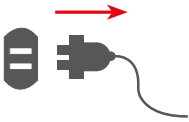

2.

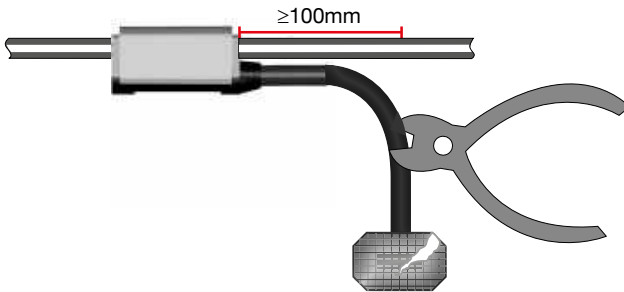

3.

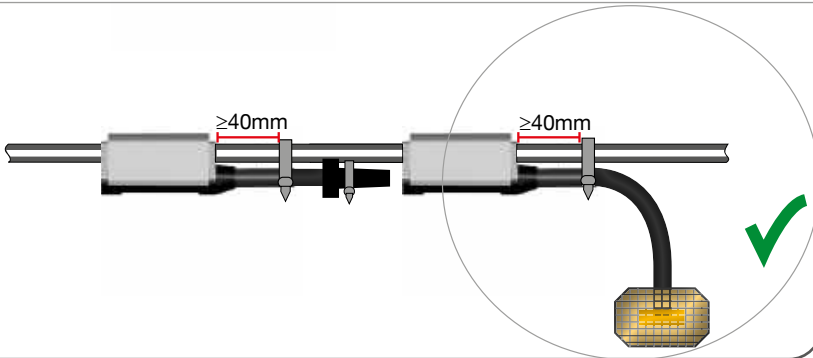
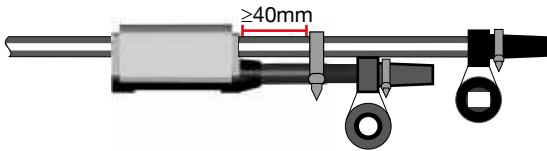

Bayonet  
2 pin

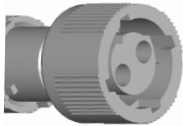

$I_{max}=16A$

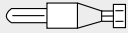

# Bayonet 2 pin female

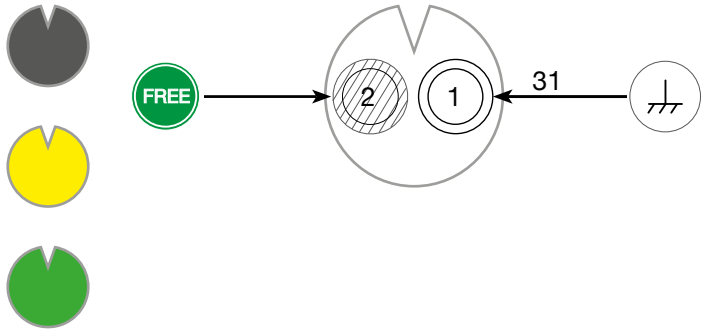

# Mounting instruction Bayonet 2 pin female

Bayonet  
2 pin

SPARE PART NO.: 13-0246-004

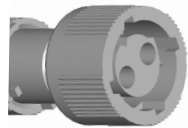
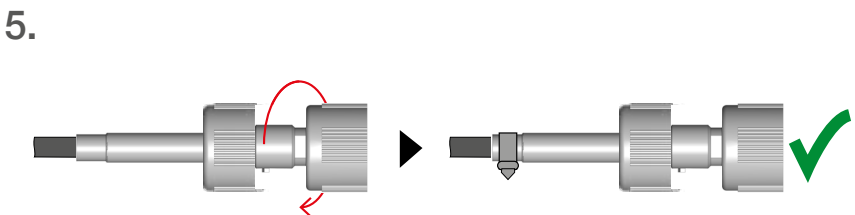
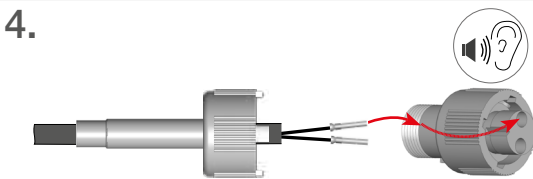
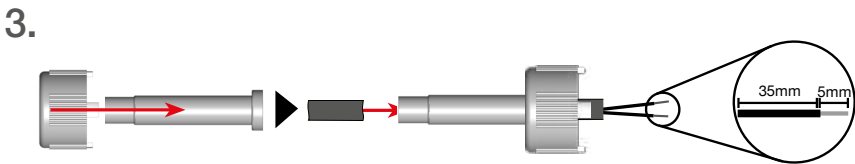
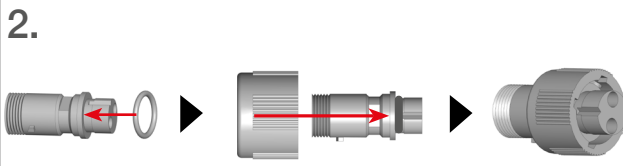
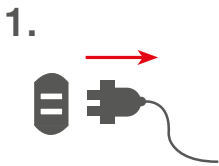
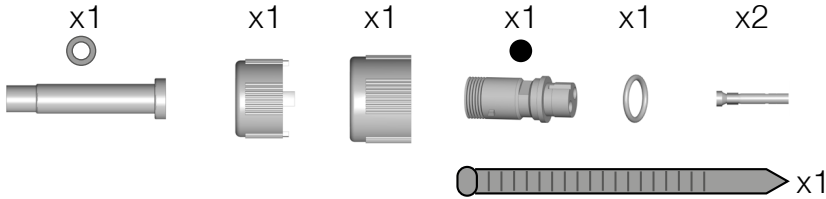

I<sub>max</sub>=16A



Bayonet  
2 pin

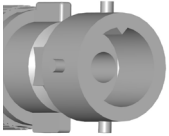

# Bayonet 2 pin male

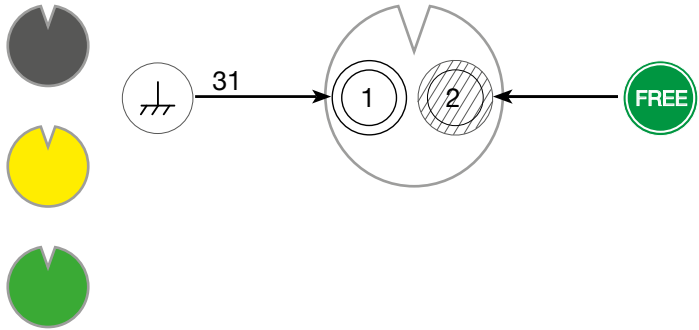
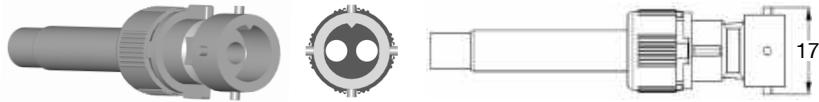

$I_{max}=16A$





# Mounting instruction Bayonet 2 pin male

Bayonet  
2 pin

SPARE PART NO.: 13-0236-004

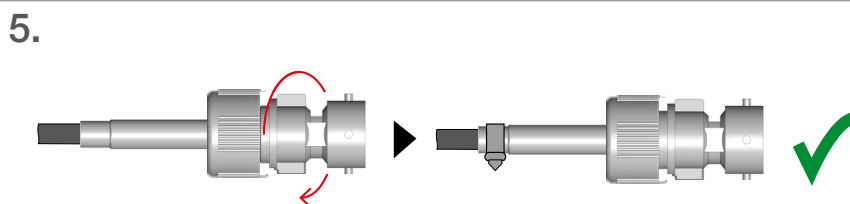
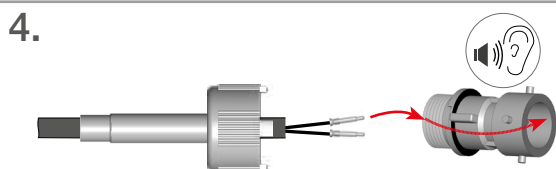
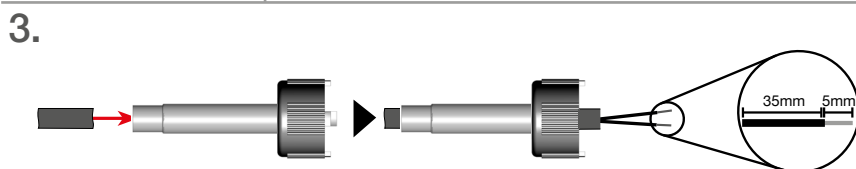
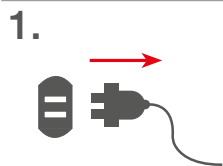
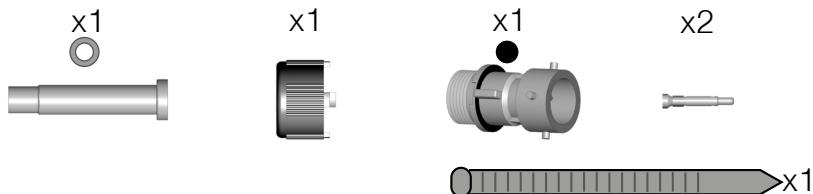

I<sub>max</sub>=16A

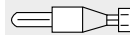

Bayonet  
5 pin

# Bayonet 5 pin female

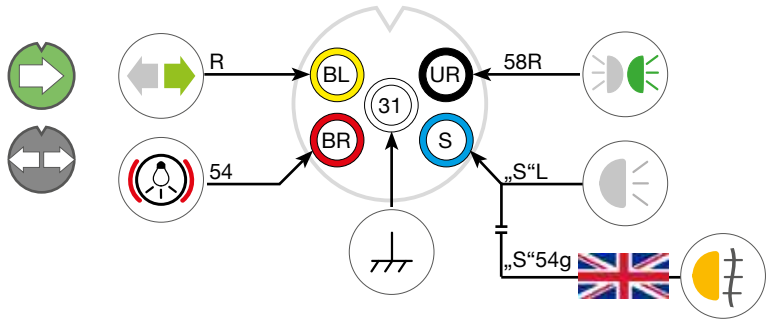
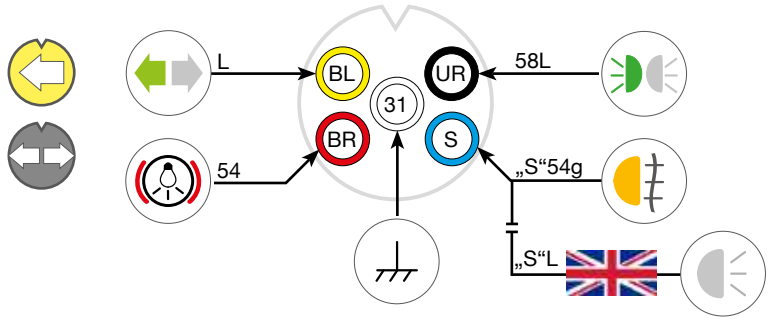

$I_{max}=16A$



# Mounting instruction Bayonet 5 pin female

Bayonet  
5 pin

SPARE PART NO.: 13-0521-104

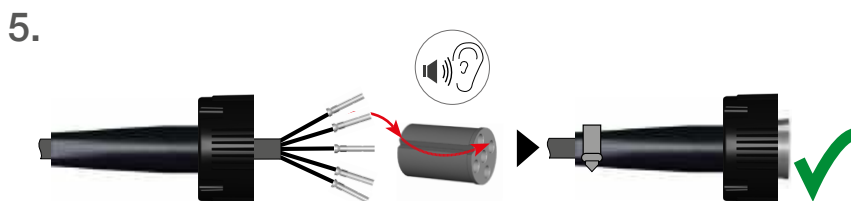
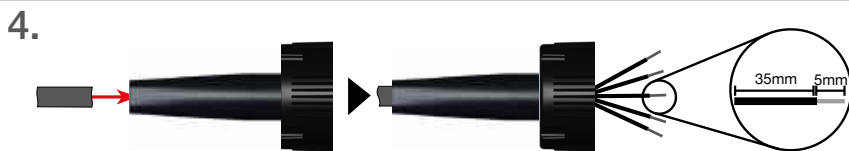
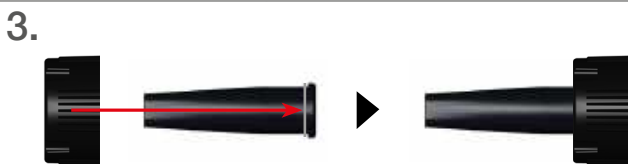
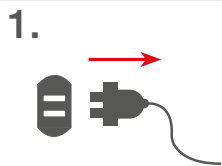
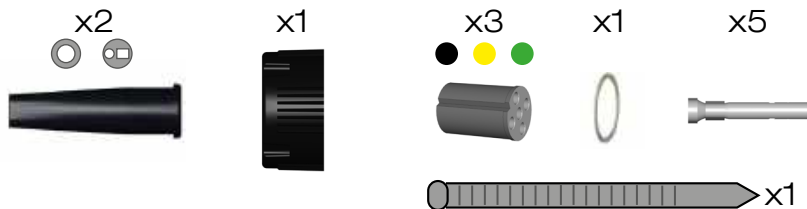

I<sub>max</sub>=16A

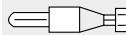

Bayonet  
5 pin



# Bayonet 5 pin male

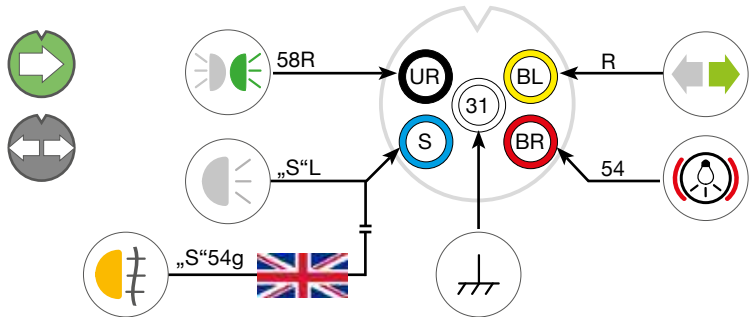
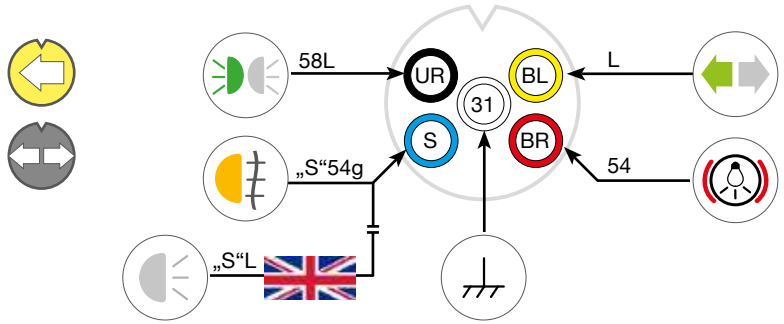
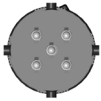
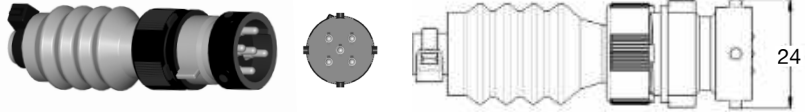

$I_{max}=16A$



# Mounting instruction Bayonet 5 pin male

Bayonet  
5 pin

SPARE PART NO.: 13-0536-044

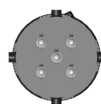
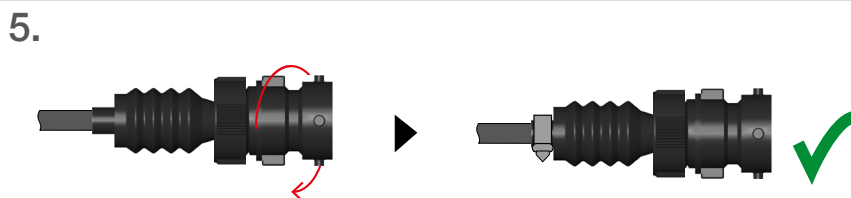
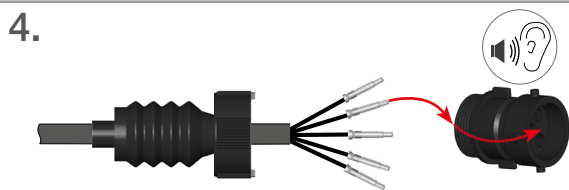
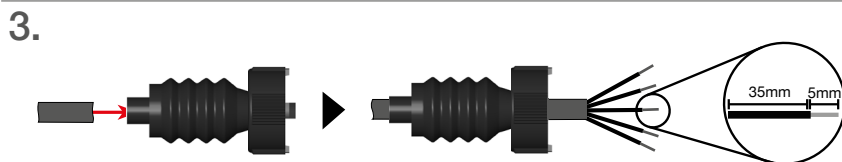
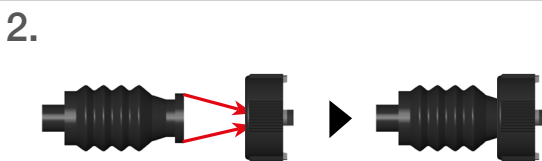
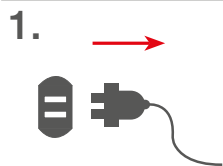
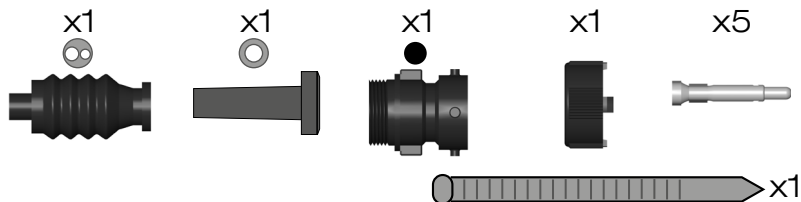

I<sub>max</sub>=16A

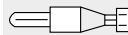

Bayonet  
8 pin

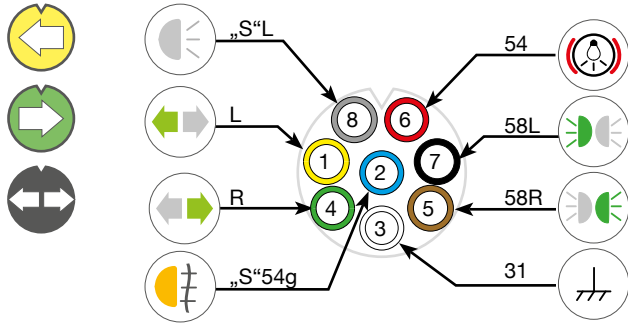
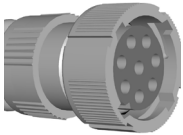
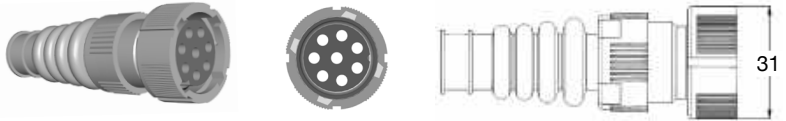

$I_{max}=16A$



# Mounting instruction Bayonet 8 pin female

Bayonet  
8 pin

SPARE PART NO.: 13-0828-034

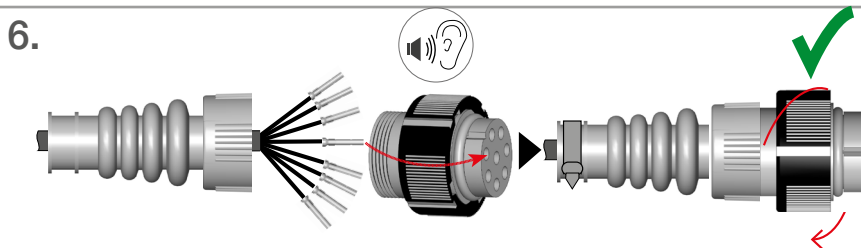
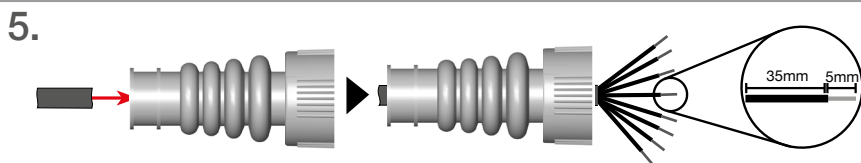
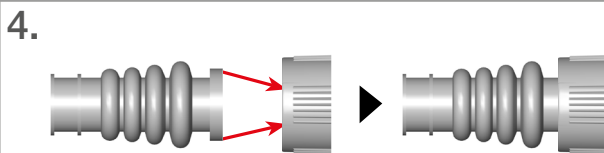
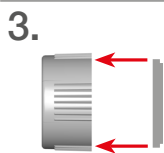
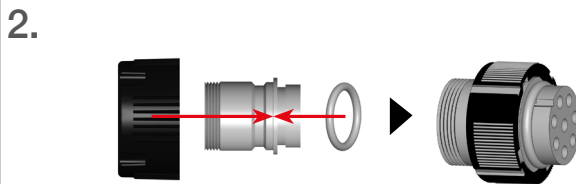
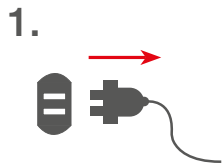
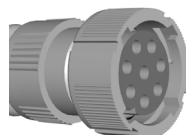
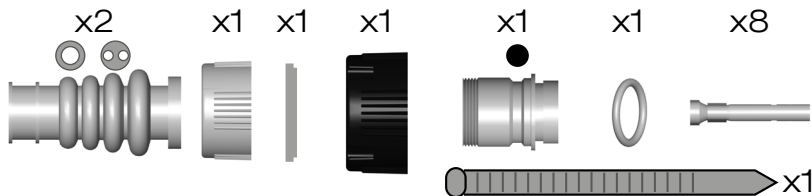

I<sub>max</sub>=16A



Bayonet  
8 pin



# Bayonet 8 pin female

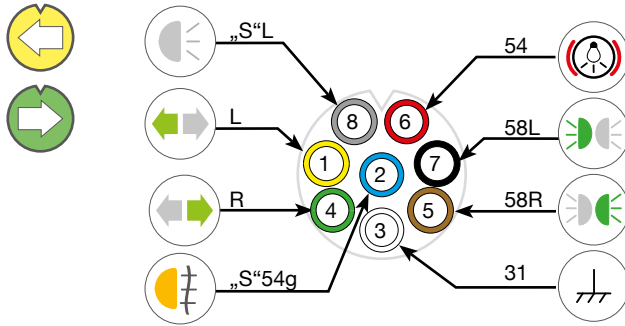
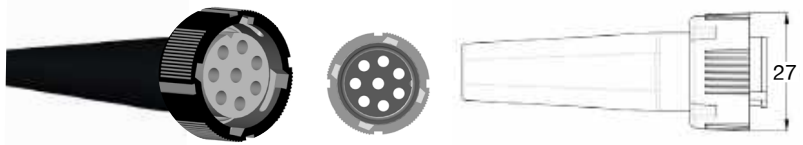

$I_{max}=16A$





# Mounting instruction Bayonet 8 pin female



Aspöck Standard

Bayonet  
8 pin

SPARE PART NO.: 15-0821-524

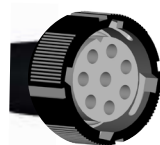
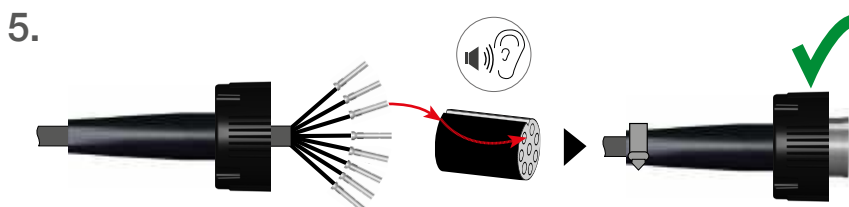
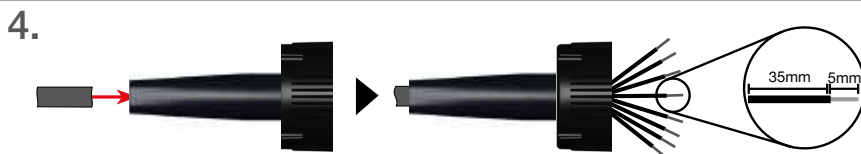
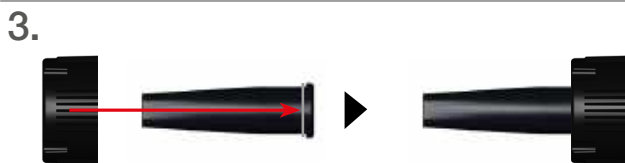
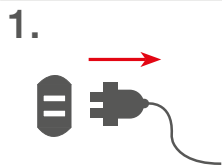
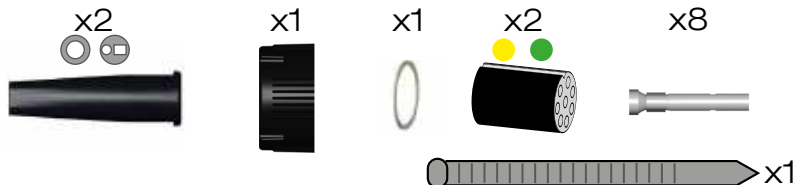

I<sub>max</sub>=16A

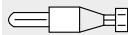

Bayonet  
8 pin

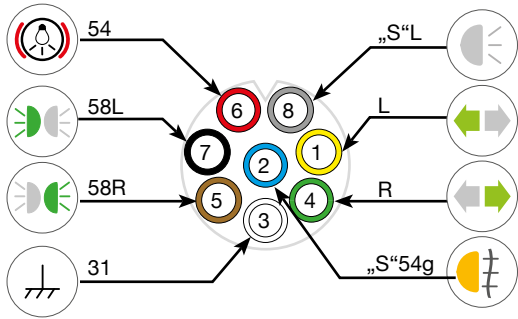
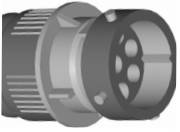
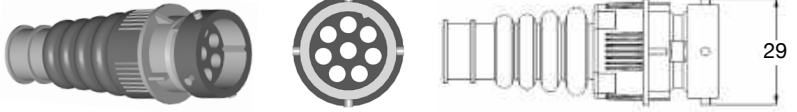

$I_{max}=16A$

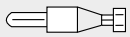

# Mounting instruction Bayonet 8 pin male

Bayonet  
8 pin

SPARE PART NO.: 13-0838-054

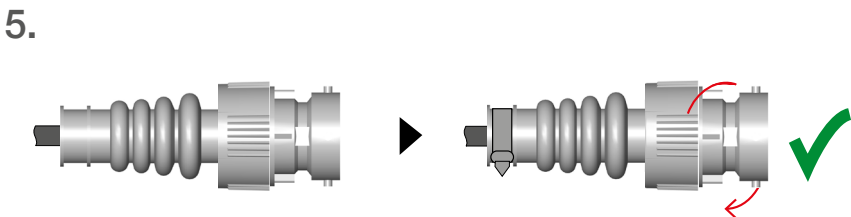
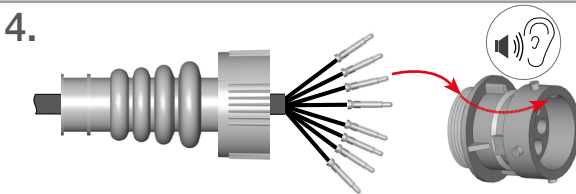
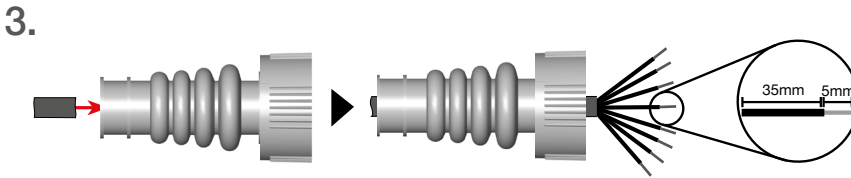
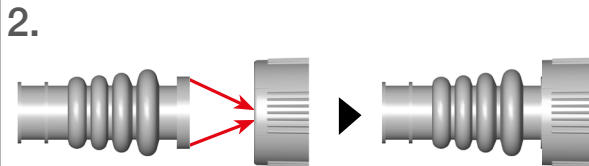
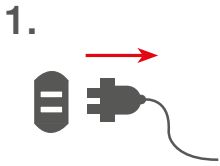
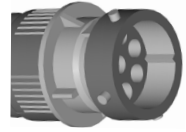
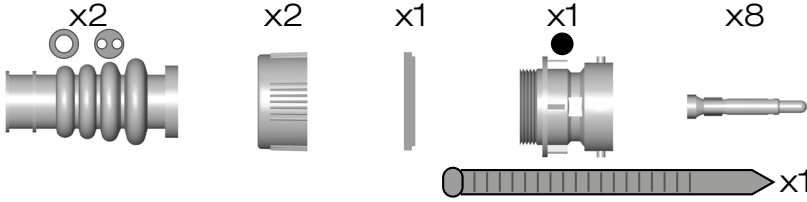

I<sub>max</sub>=16A



Bayonet  
15 pin

# Bayonet 15 pin female

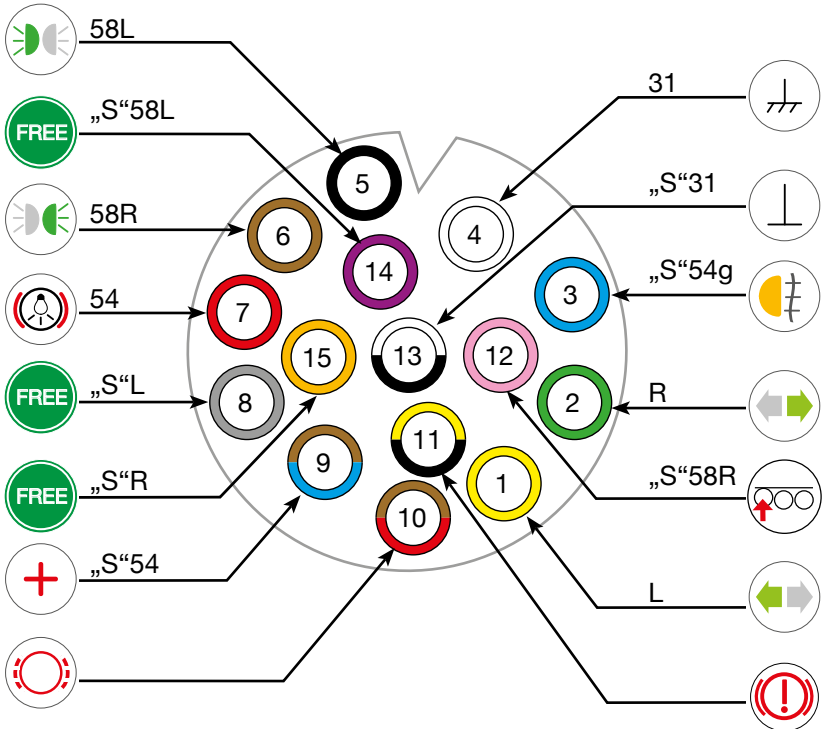
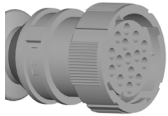
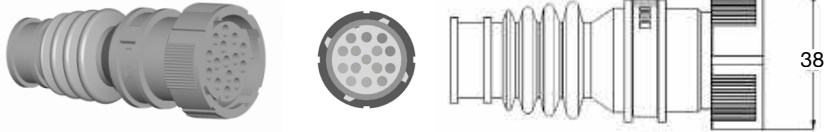

Imax=16A

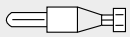

# Mounting instruction Bayonet 15 pin female

SPARE PART NO.: 13-1540-004

Bayonet  
15 pin

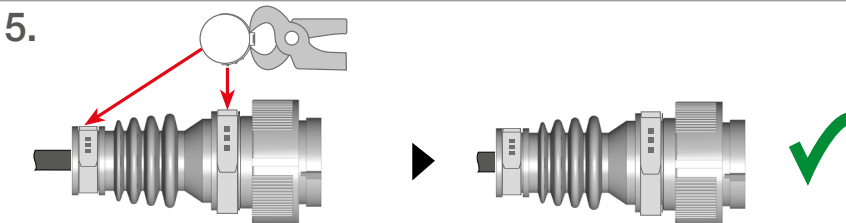
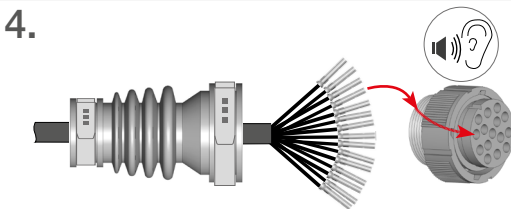
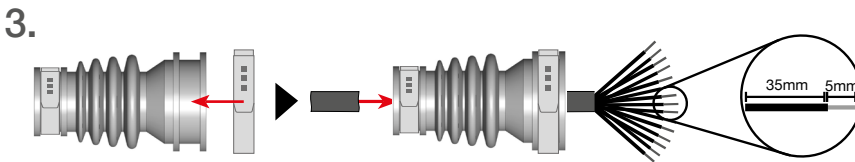
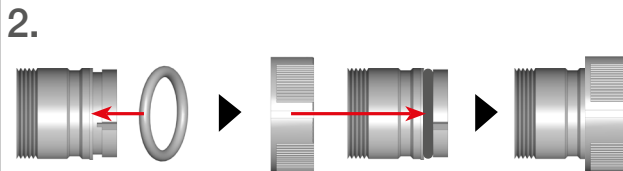
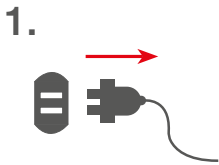
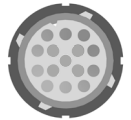
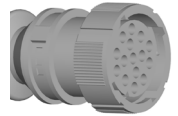
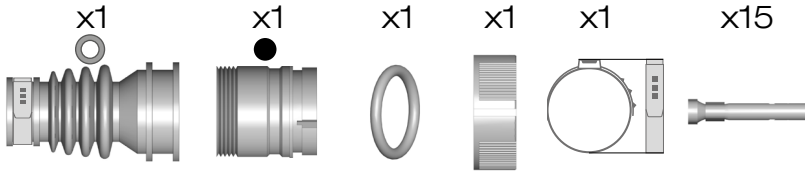

I<sub>max</sub>=16A

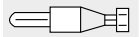

Bayonet  
15 pin

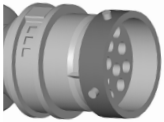

# Bayonet 15 pin male

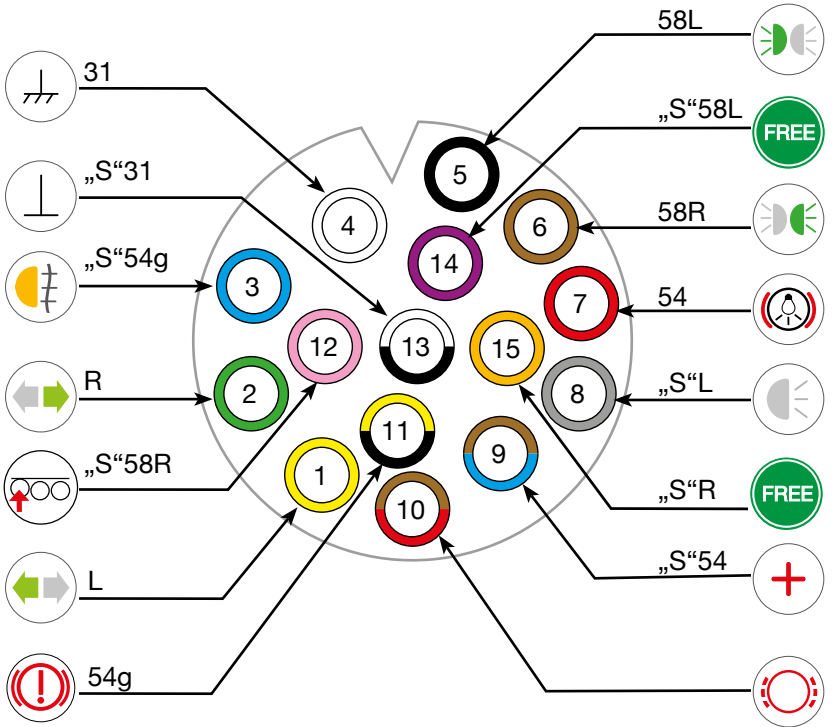
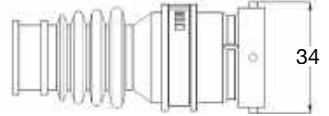

$I_{max}=16A$

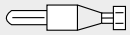

# Mounting instruction Bayonet 15 pin male

Bayonet  
15 pin

SPARE PART NO.: 13-1530-004

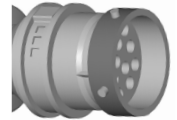
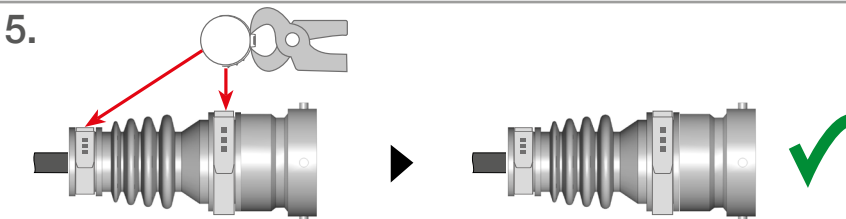
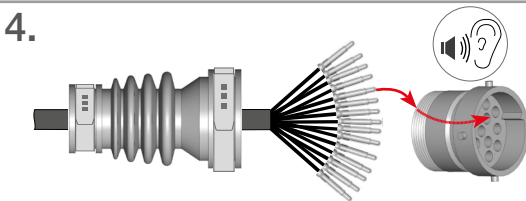
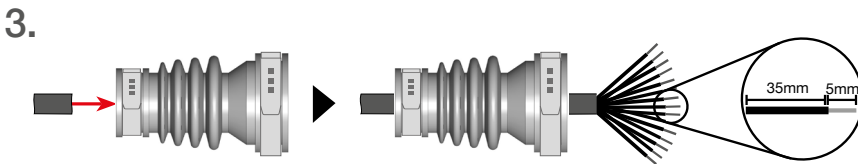
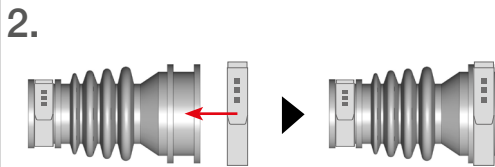
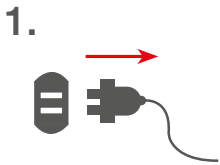
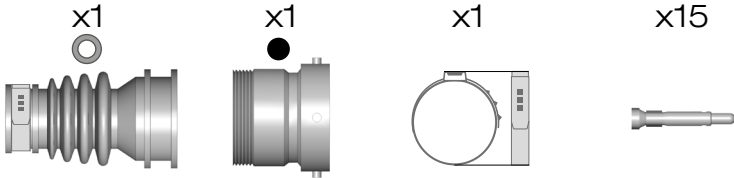

$I_{max}=16A$



ASS1,  
ASS2  
2 pin

# ASS1, ASS2 2 pin female

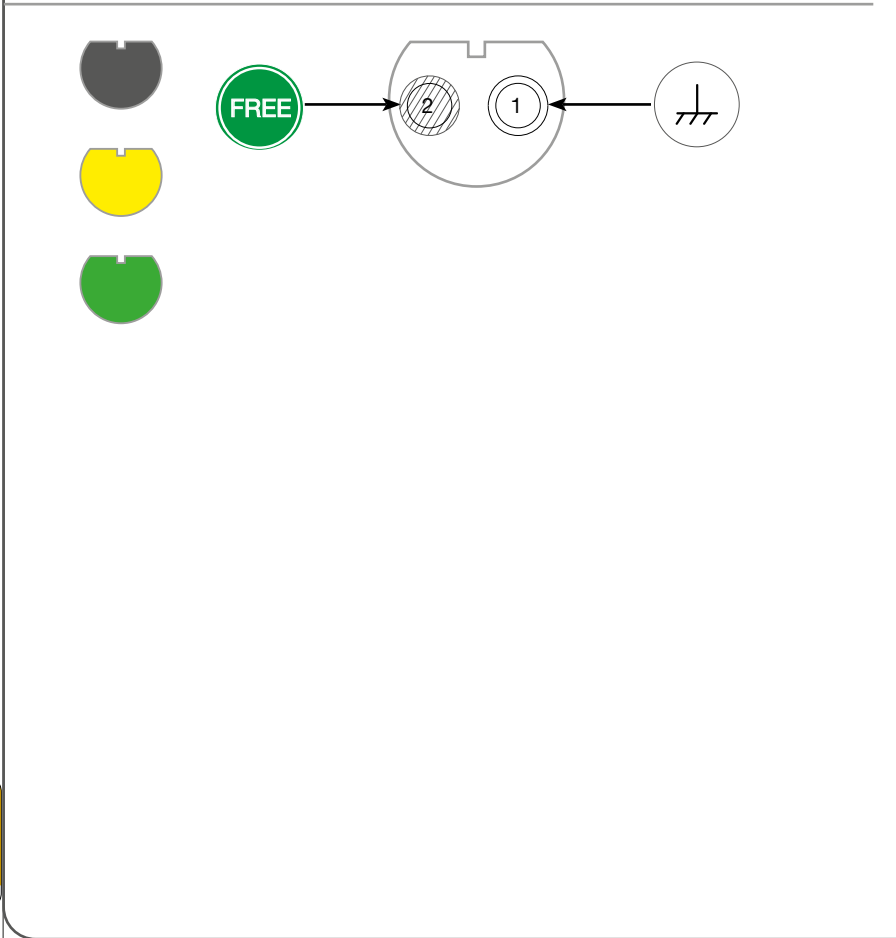
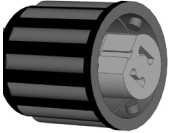

$I_{max}=25A$



ASS 1      ASS 2





ASS1,  
ASS2  
2 pin



Imax=25A



# Mounting instruction ASS1, ASS2 2 pin female

SPARE PART NO.: 13-5626-401

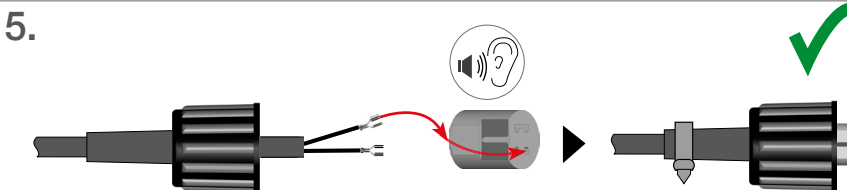
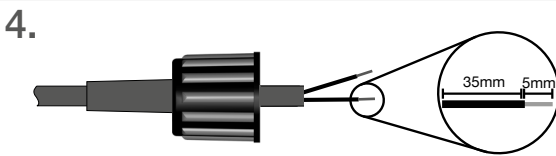
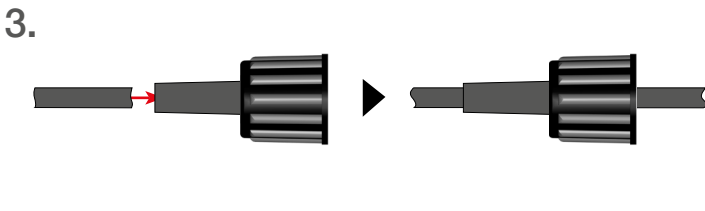
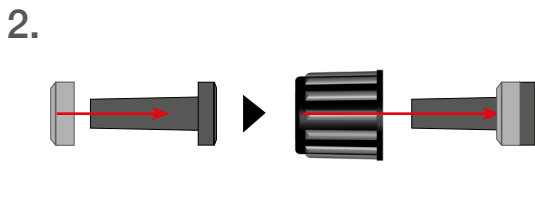
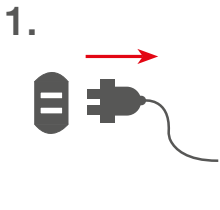
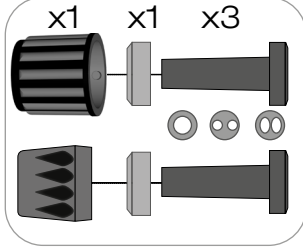
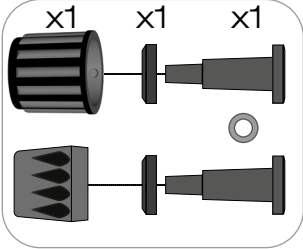

ASS1,  
ASS2  
2 pin

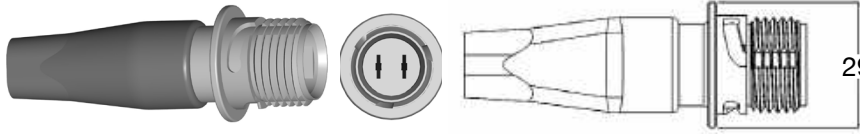

29

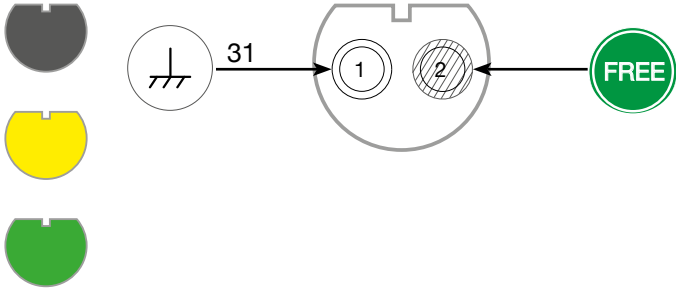
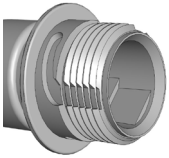

$I_{max}=25A$

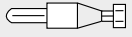

ASS 1

ASS 2



ADR-Zone 2  
approved

IP68



ADR-Zone 2  
approved

IP6K9K

# Mounting instruction ASS1, ASS2 2 pin male



Aspöck Standard

ASS1,  
ASS2  
2 pin

SPARE PART NO.: 13-5625-991

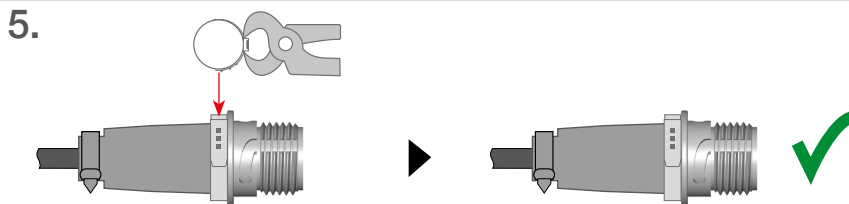
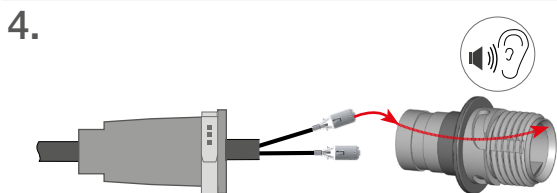
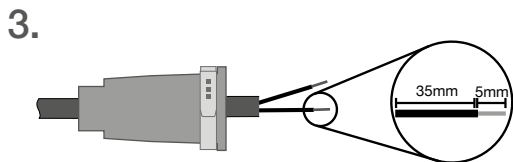
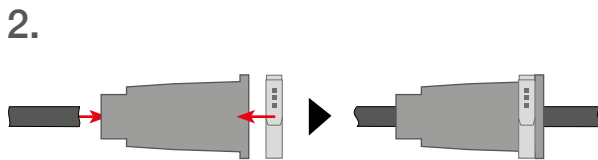
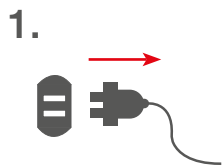
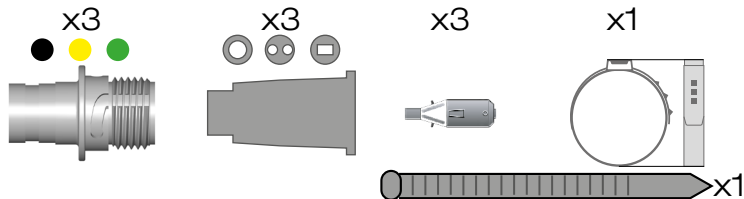

Imax=25A

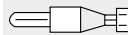

ASS1,  
ASS2,  
ASS2.1,  
7 pin

# ASS1, ASS2, ASS2.1 7 pin female

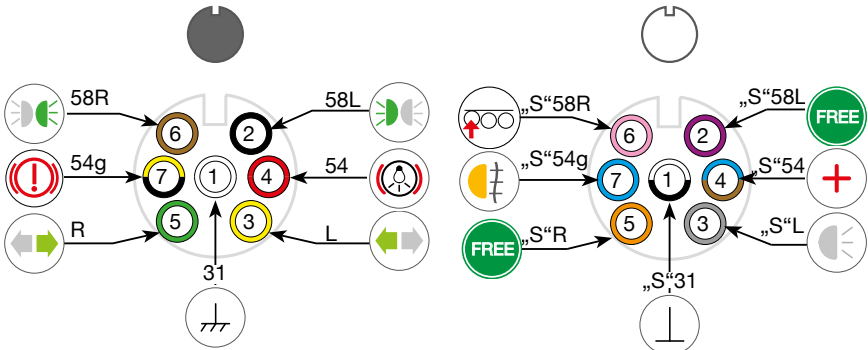
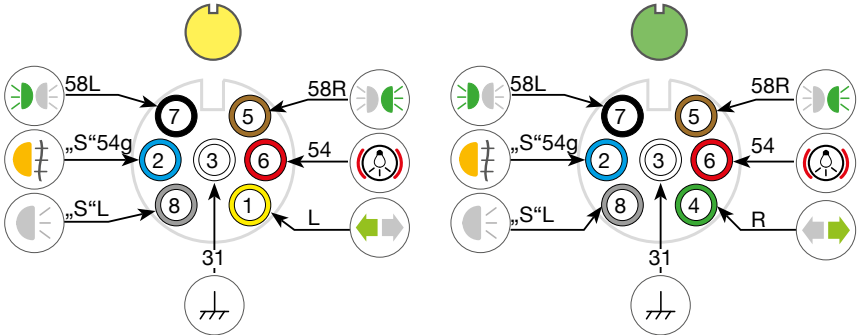

Imax=25A



ASS 1 ASS 2,2.1



# Mounting instruction ASS1, ASS2 7 pin female



Aspöck Standard

ASS1,  
ASS2,  
ASS2.1,  
7 pin

SPARE PART NO.: 13-5626-631

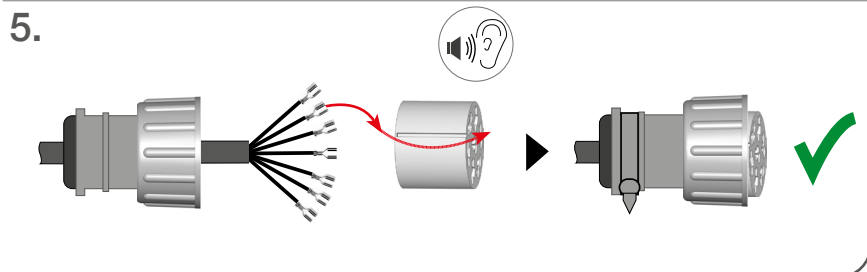
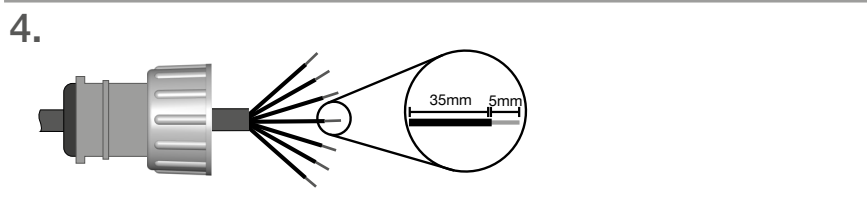
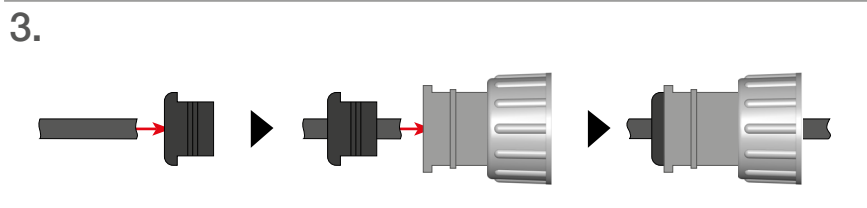
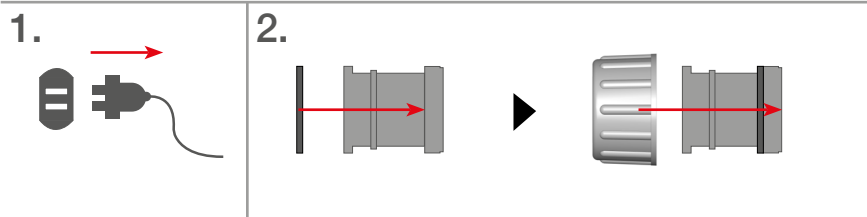
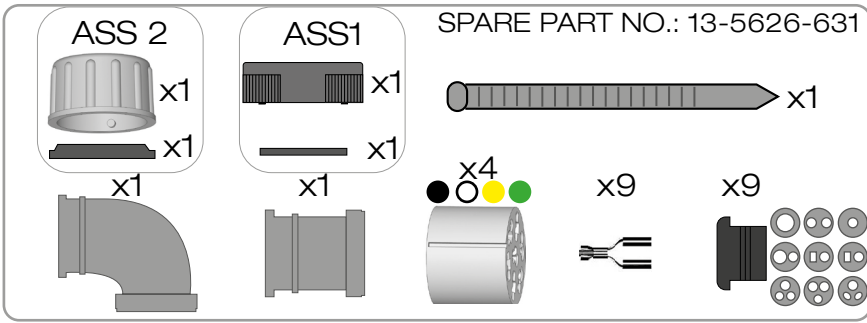

Imax=25A



ASS1,  
ASS2,  
ASS2.1,  
7 pin

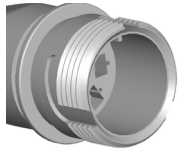

# ASS1, ASS2, ASS2.1 7 pin male

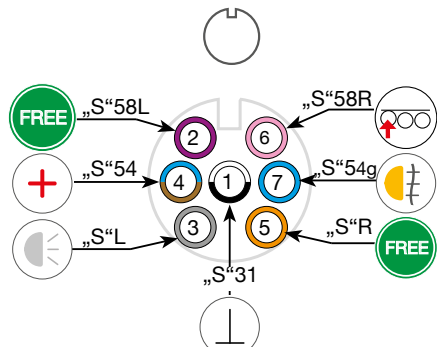
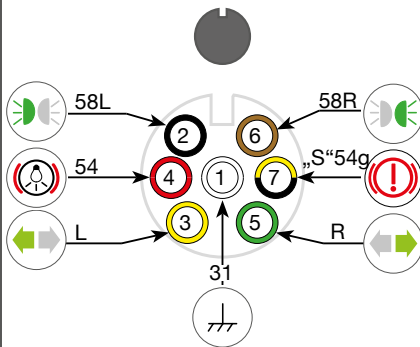
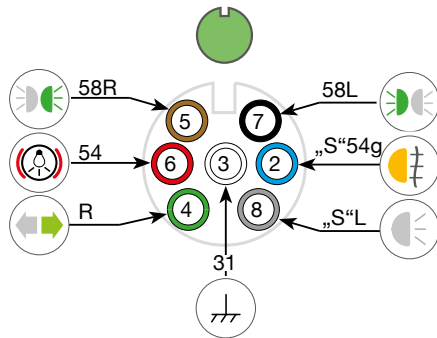
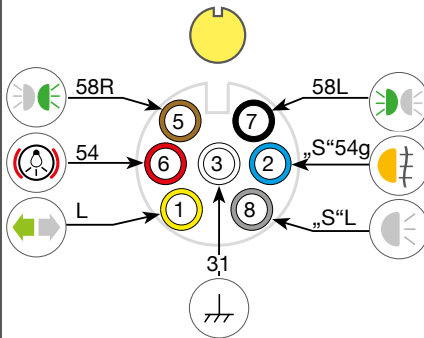
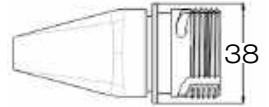
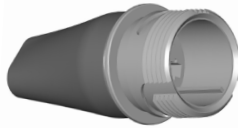

Imax=25A

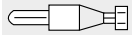

ASS 1 ASS 2,2.1



# Mounting instruction ASS1, ASS2 7 pin male



Aspöck Standard

ASS1,  
ASS2,  
ASS2.1,  
7 pin

SPARE PART NO.: 13-5625-981

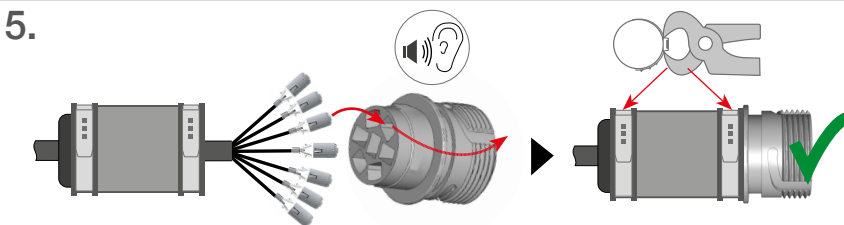
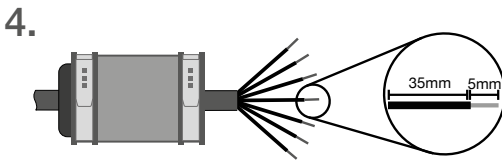
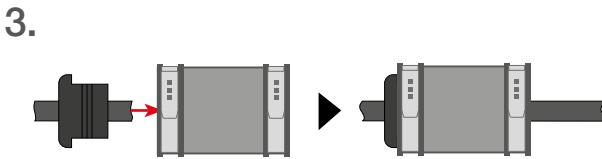
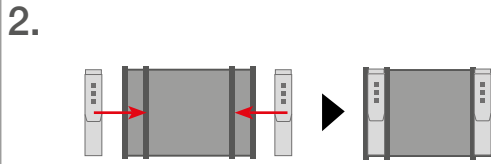
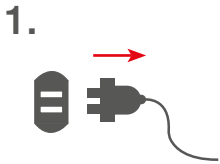
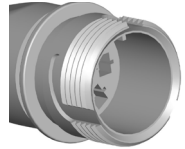
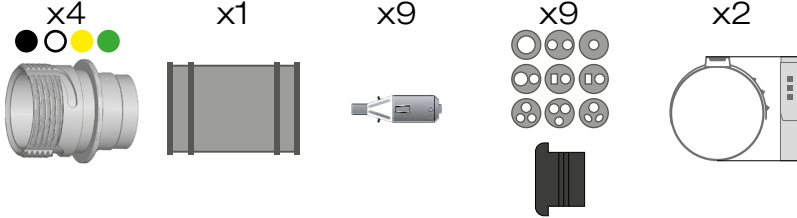

Imax=25A



ASS3  
3 pin

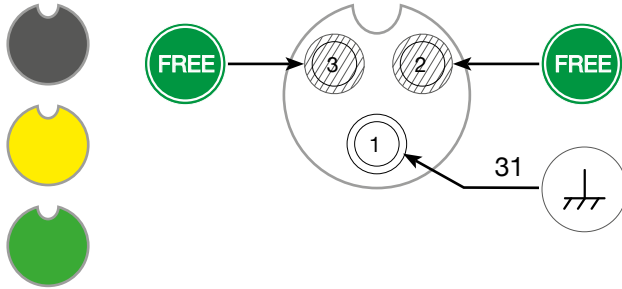

$I_{max}=16A$

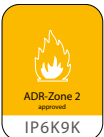



# Mounting instruction ASS3 3 pin female



Aspöck Standard

ASS3  
3 pin

SPARE PART NO.: 13-0322-281

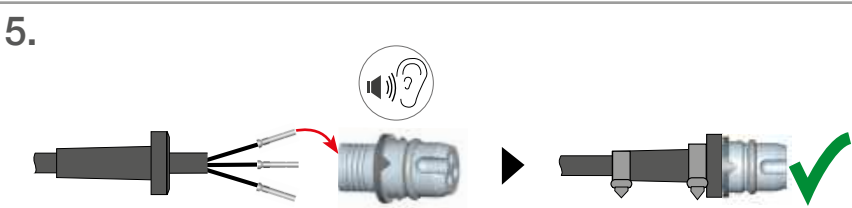
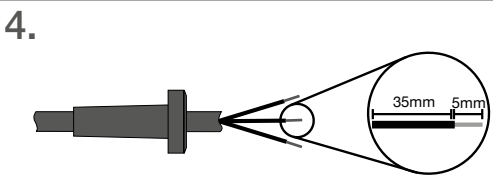
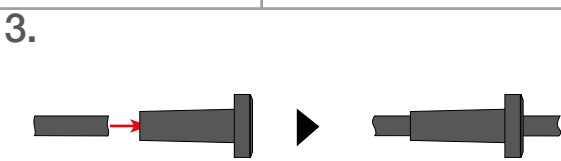
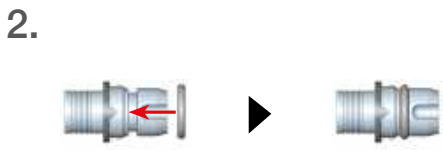
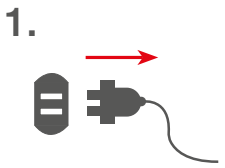
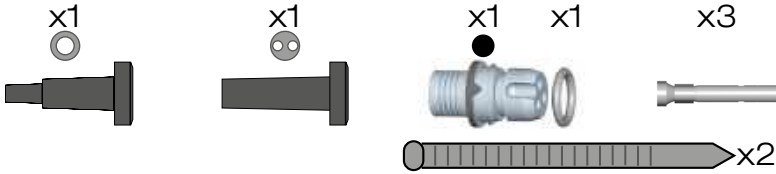

$I_{max}=16A$



ASS3  
3 pin

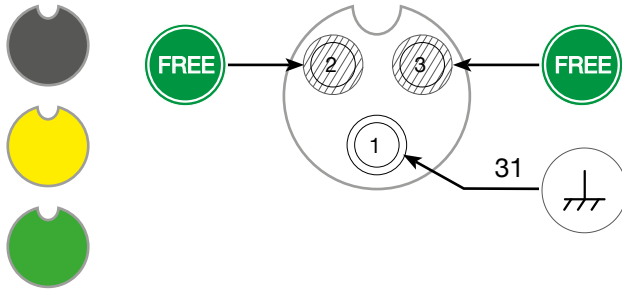

$I_{max}=16A$

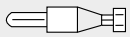

# Mounting instruction ASS3 3 pin male

ASS3  
3 pin

SPARE PART NO.: 13-0332-281

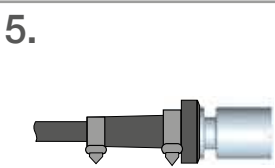
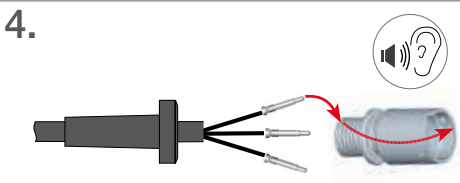
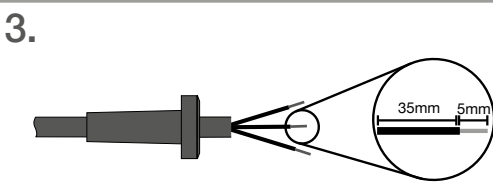
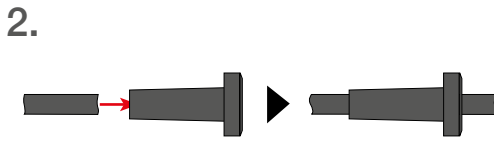
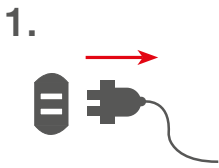
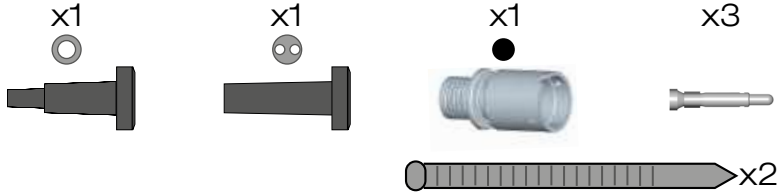

Imax=16A



ASS3  
17 pin



# ASS3 17 pin female

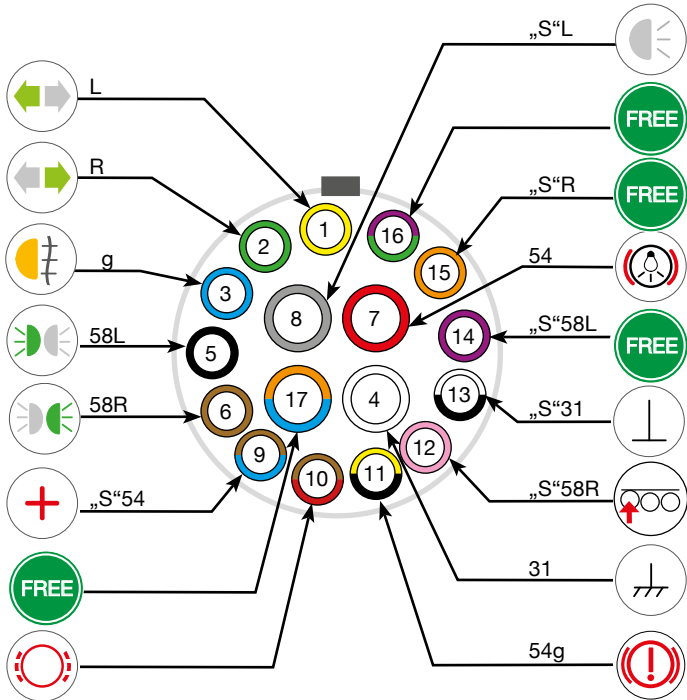

$I_{max}=16A$

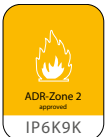

# Mounting instruction ASS3 17 pin female

ASS3  
17 pin

SPARE PART NO.: 13-1722-001

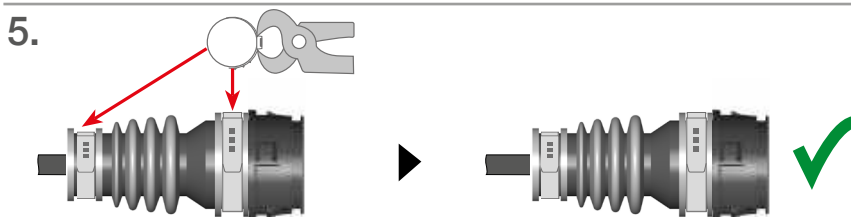
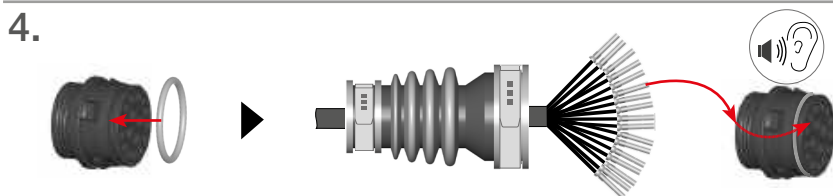
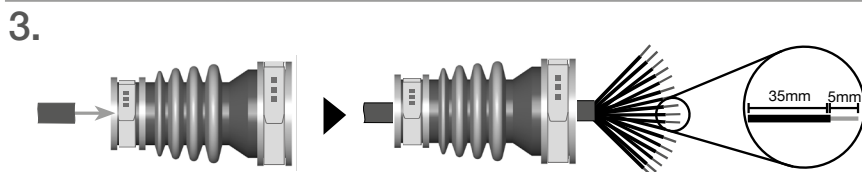
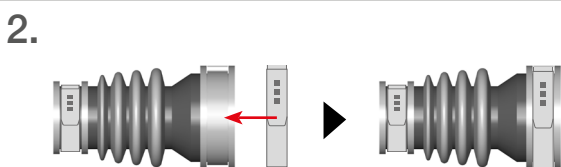
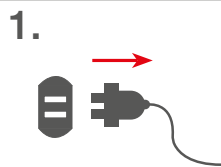
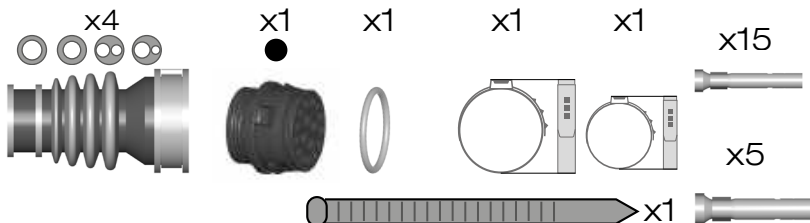

Imax=16A

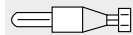

ASS3  
17 pin



# ASS3 17 pin male

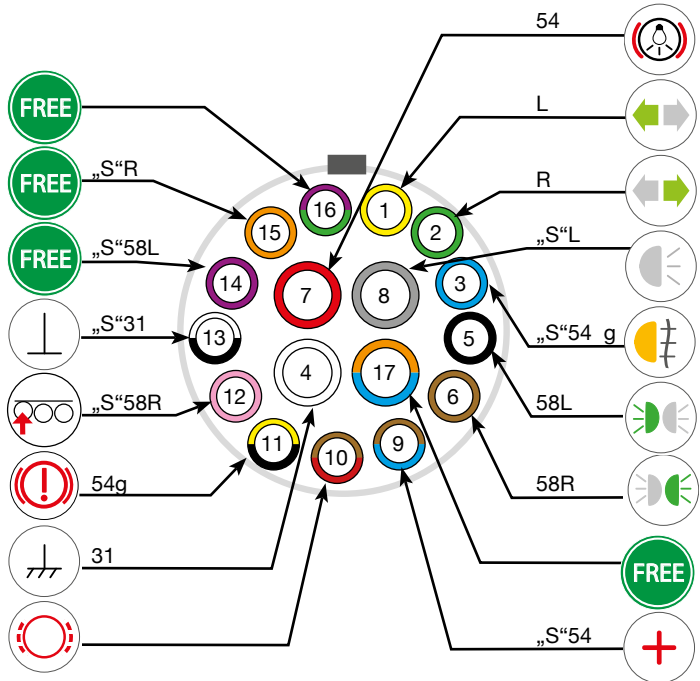
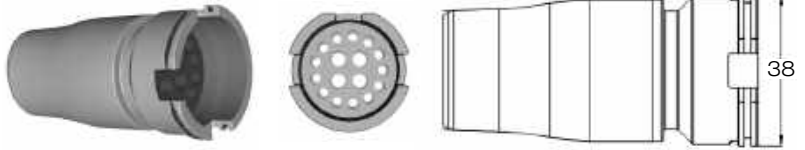

Imax=16A



# Mounting instruction ASS3 17 pin male

SPARE PART NO.: 13-1732-001

ASS3  
17 pin

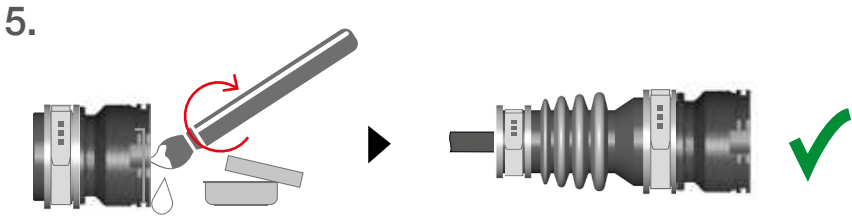
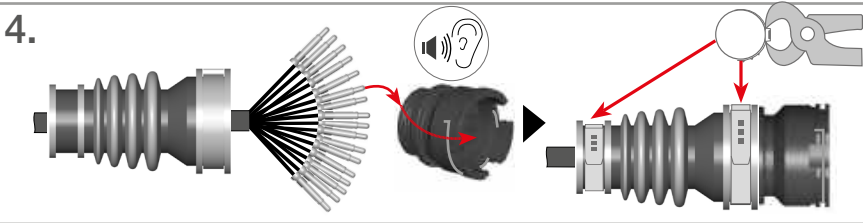
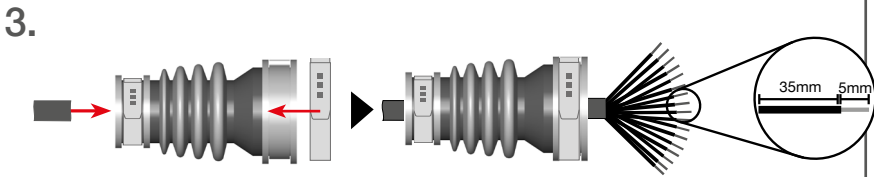
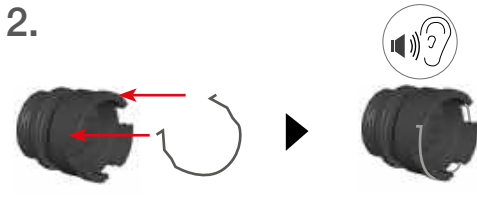
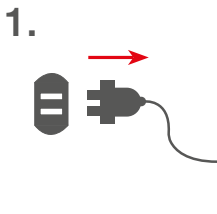
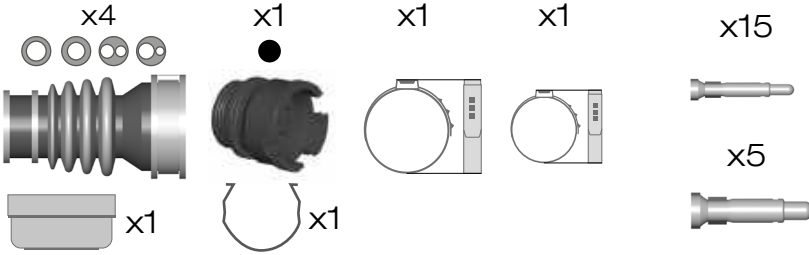

$I_{max}=16A$



# AMP 4 pin female

AMP  
4 pin

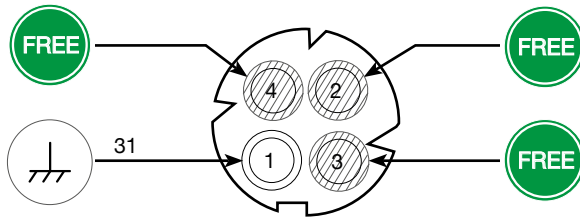

$I_{max}=40A$





# Mounting instruction AMP 4 pin female

SPARE PART NO.: 15-7002-004

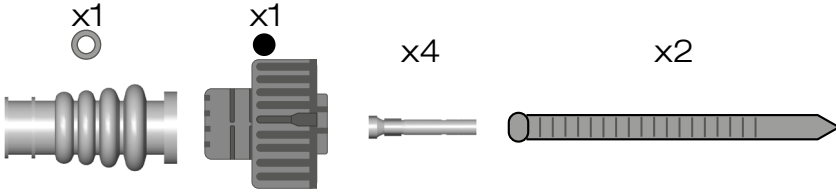

AMP  
4 pin

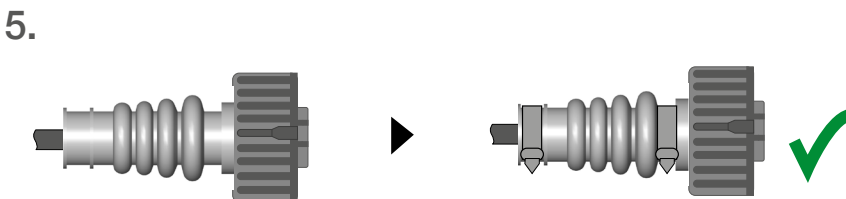
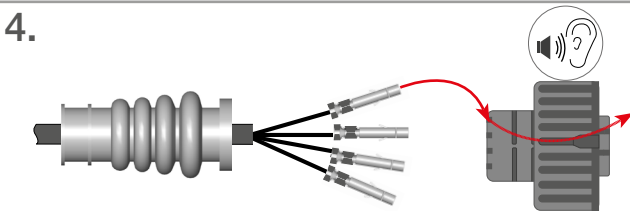
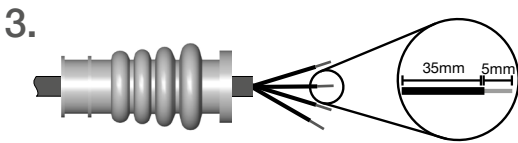
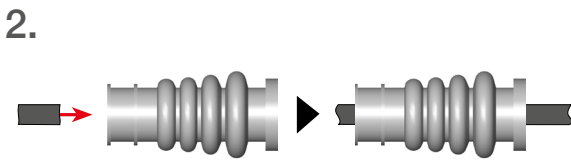
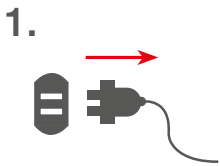

$I_{max}=40A$



# AMP 4 pin male

AMP  
4 pin

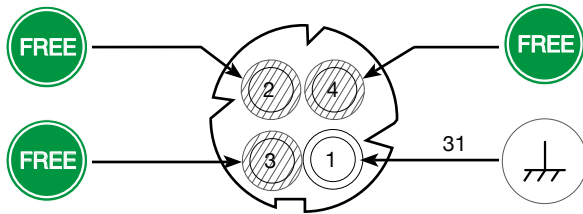

$I_{max}=40A$

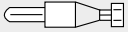

# Mounting instruction AMP 4 pin male

SPARE PART NO.: 15-7002-014

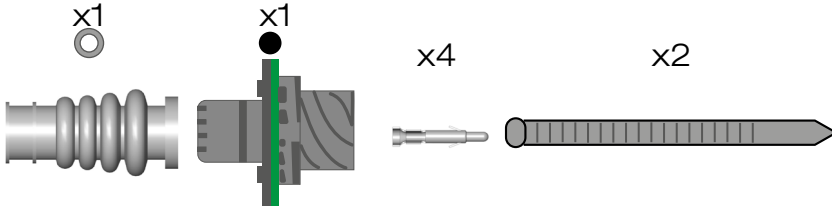

AMP  
4 pin

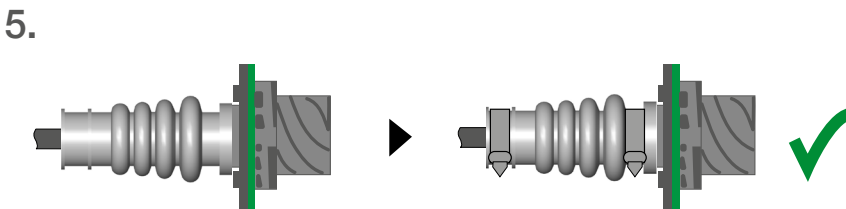
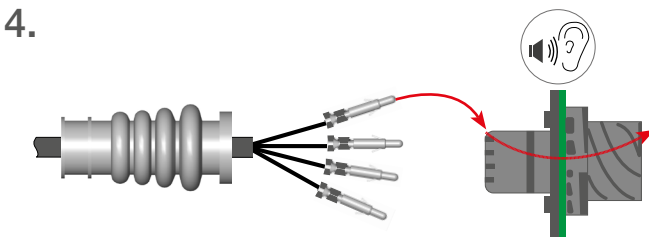
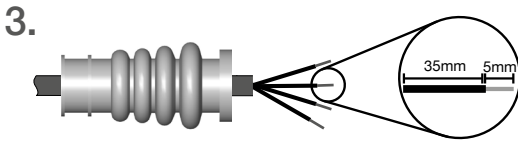
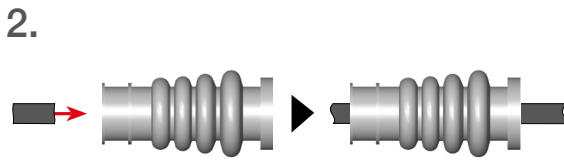
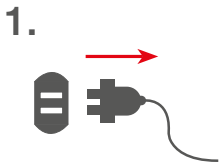

$I_{max}=40A$



# AMP 7 pin female

AMP  
7 pin

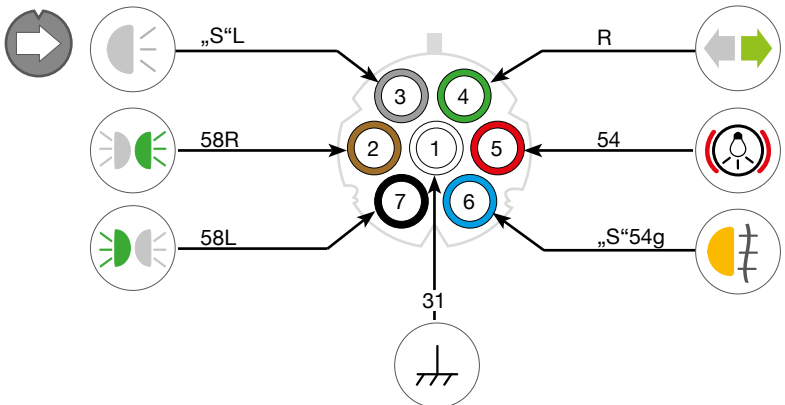
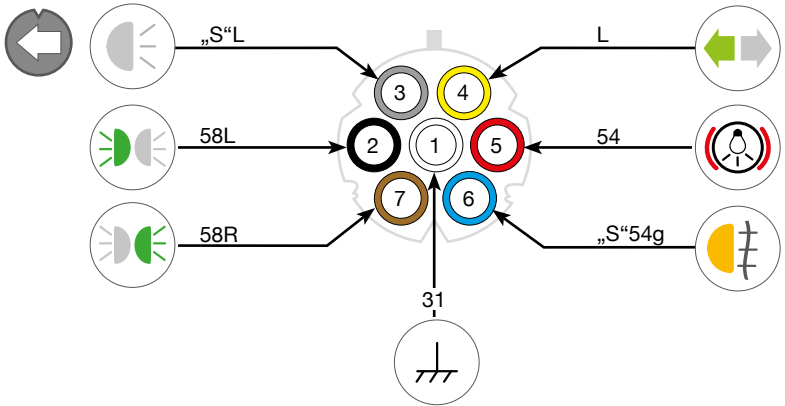

$I_{max}=30A$



# Mounting instruction AMP 7 pin female

SPARE PART NO.: 15-7002-024

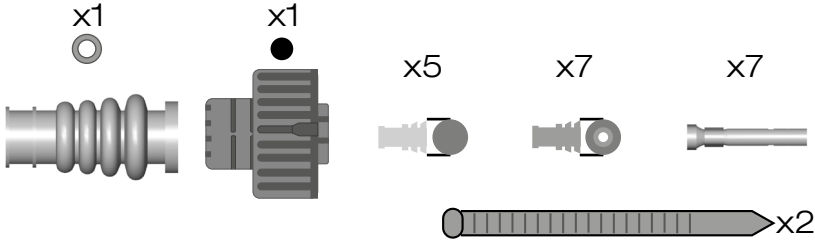

AMP  
7 pin

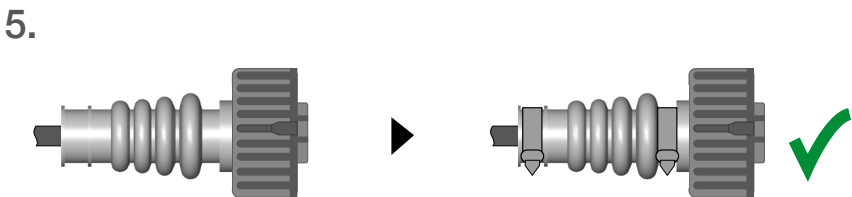
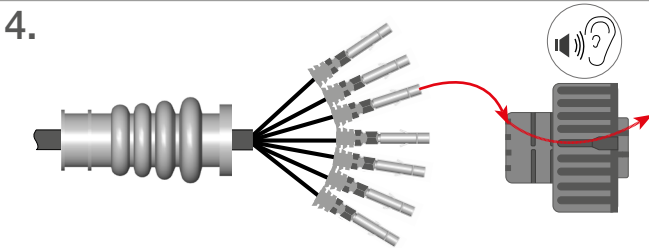
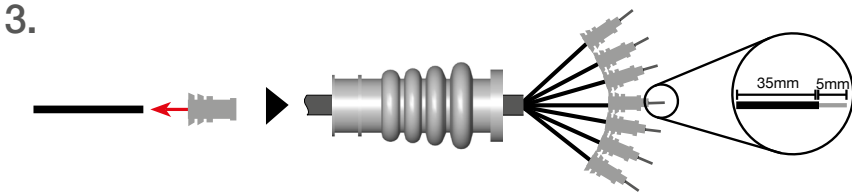
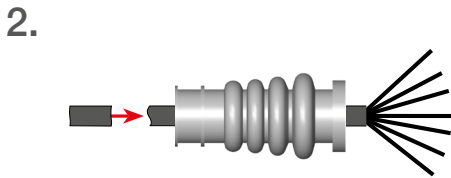
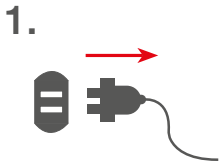

I<sub>max</sub>=30A



# AMP 7 pin male

AMP  
7 pin

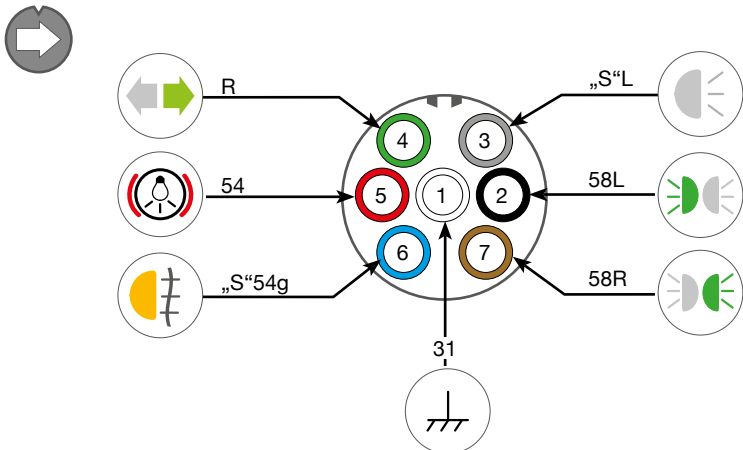
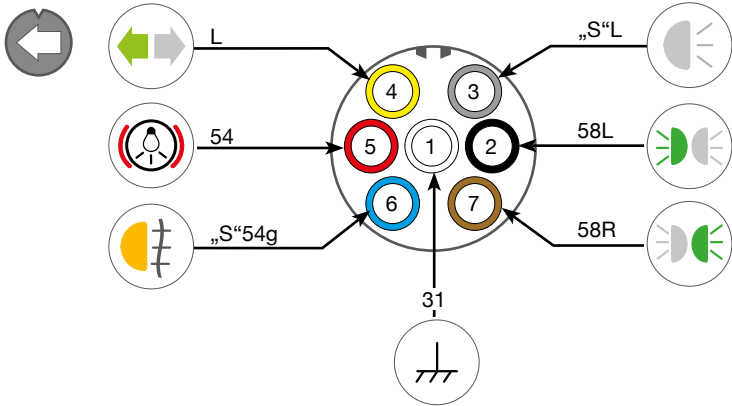

$I_{max}=30A$



# Mounting instruction AMP 7 pin male



AMP  
7 pin

SPARE PART NO.: 15-7002-034

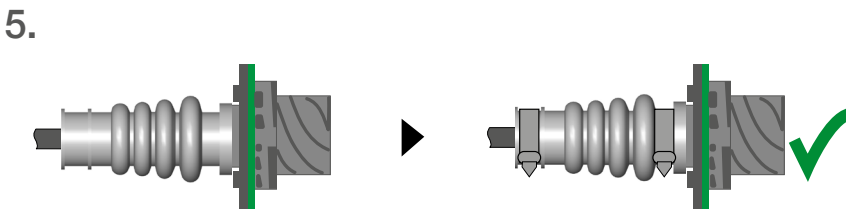
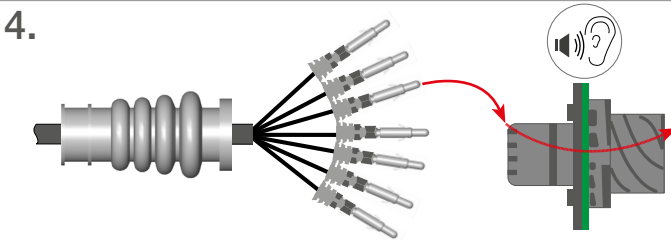
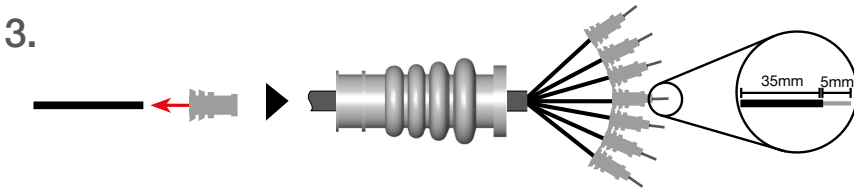
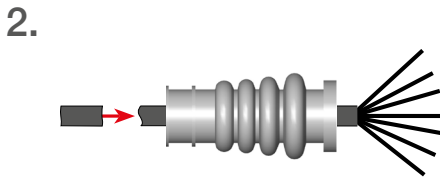
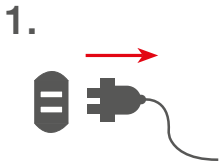
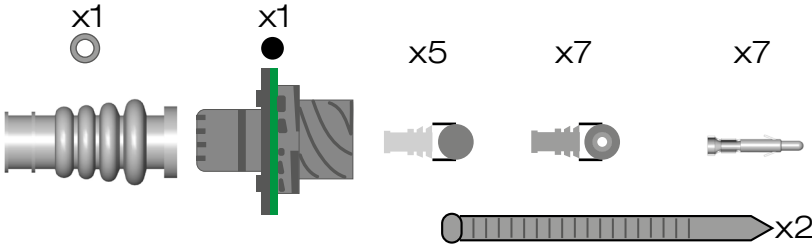

I<sub>max</sub>=30A



# SuperSeal 2 pin female

SuperSeal  
2 pin

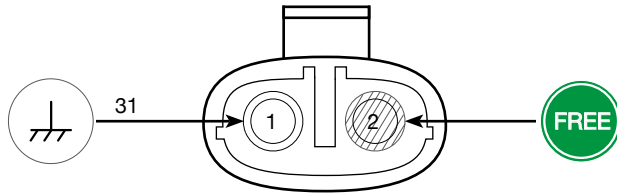

$I_{max}=14A$

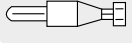



# Mounting instruction SuperSeal 2 pin female



SPARE PART NO.: 15-7002-044

SuperSeal  
2 pin

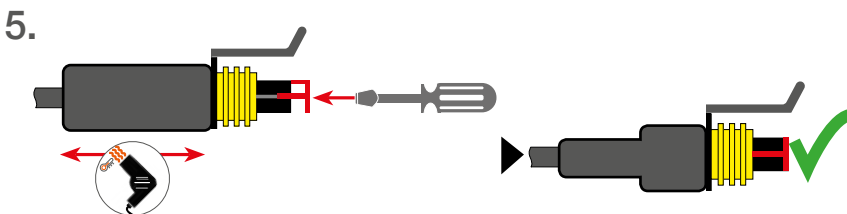
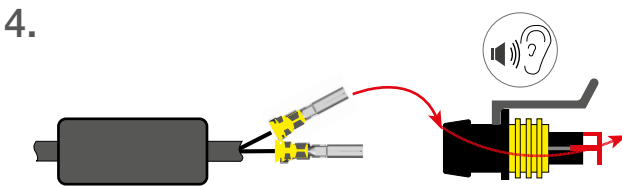
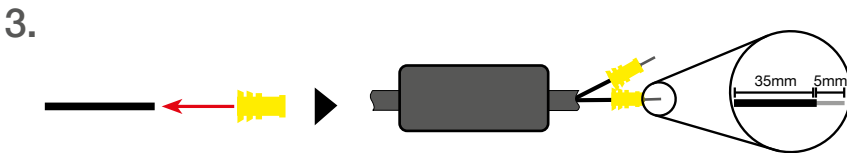
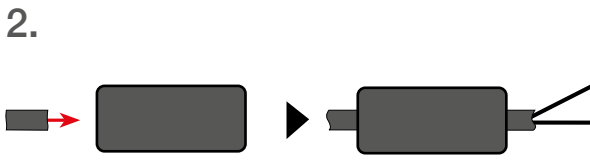
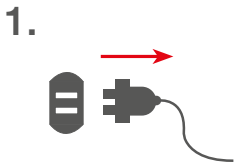
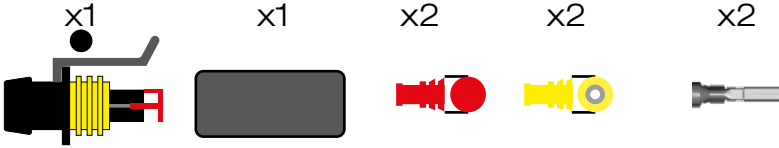

$I_{max}=14A$

# SuperSeal 2 pin male

SuperSeal  
2 pin

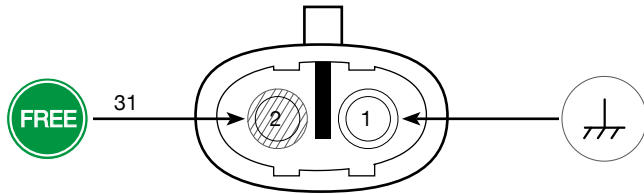
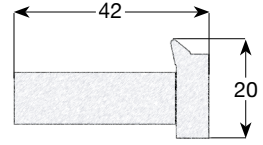
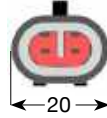

$I_{max}=14A$

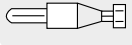

# Mounting instruction SuperSeal 2 pin male



SPARE PART NO.: 15-7002-054

SuperSeal  
2 pin

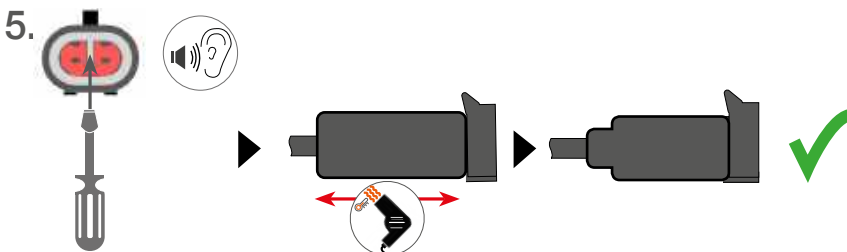
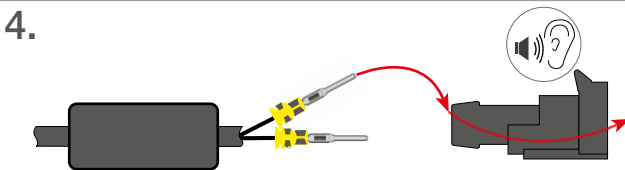
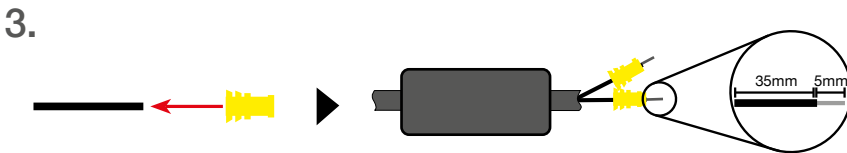
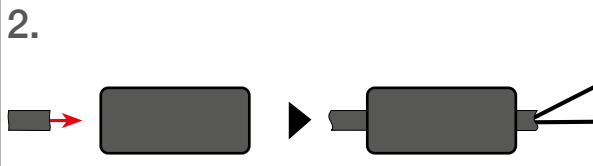
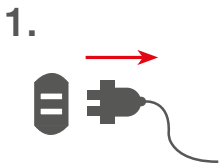
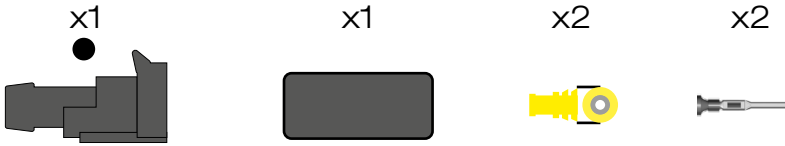

$I_{max}=14A$

# SuperSeal 3 pin female

SuperSeal  
3 pin

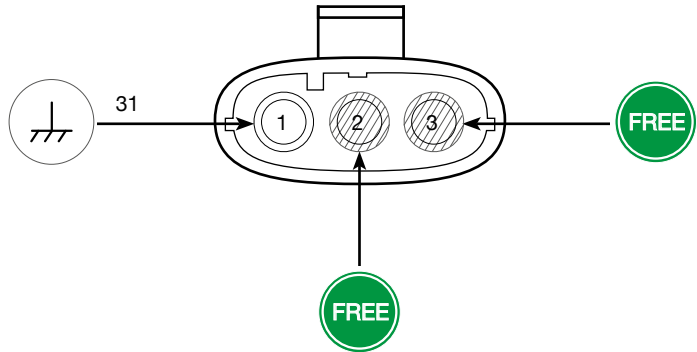
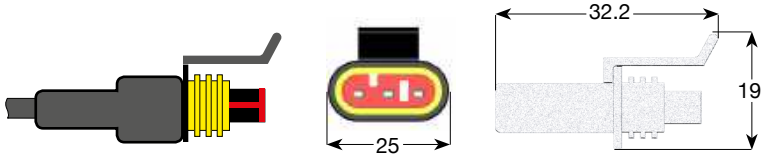

$I_{max}=14A$

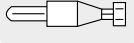

# Mounting instruction SuperSeal 3 pin female

SPARE PART NO.: 15-7002-064

SuperSeal  
3 pin

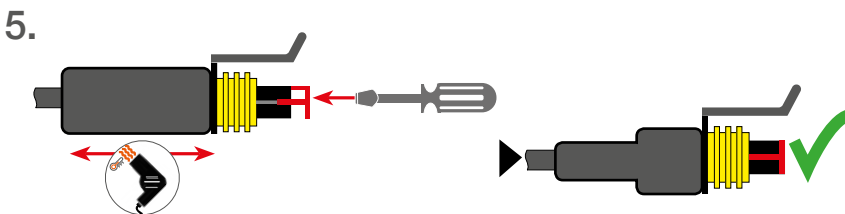
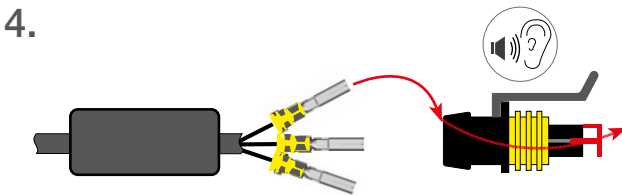
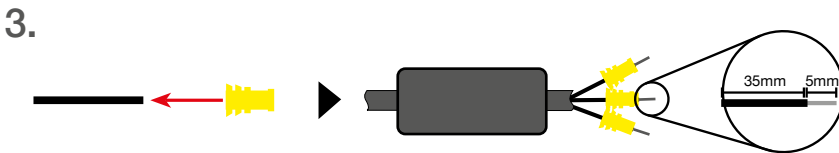
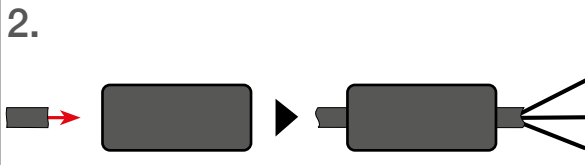
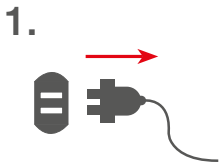
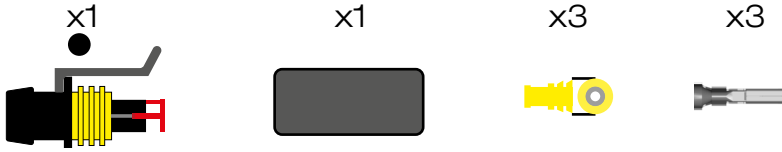

$I_{max}=14A$

# SuperSeal 3 pin male

SuperSeal  
3 pin

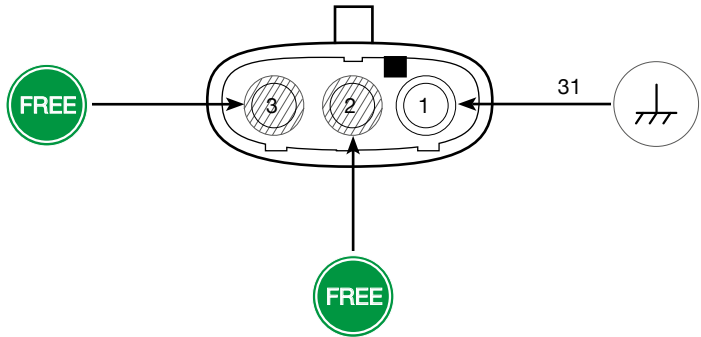
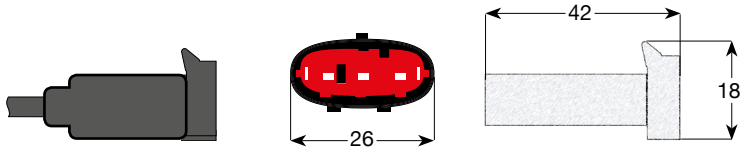

$I_{max}=14A$

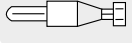

# Mounting instruction SuperSeal 3 pin male

SPARE PART NO.: 15-7002-074

SuperSeal  
3 pin

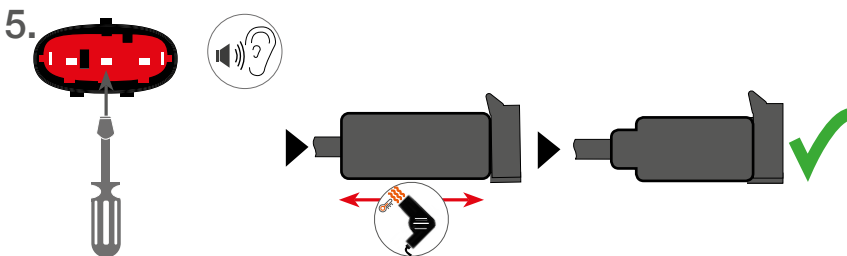
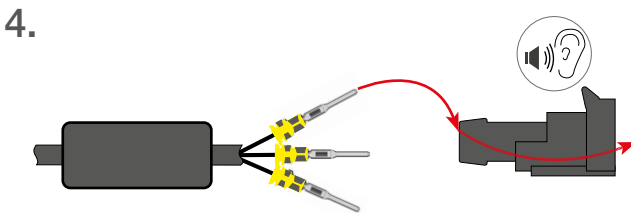
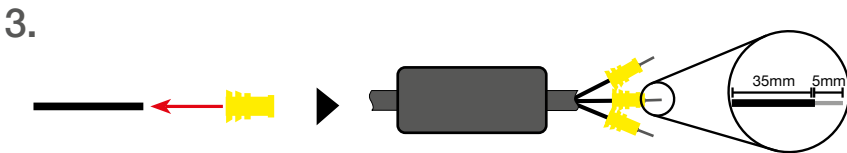
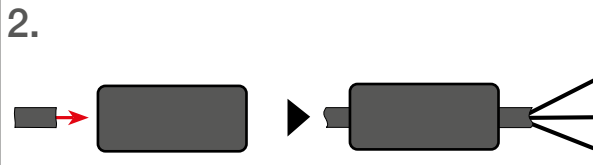
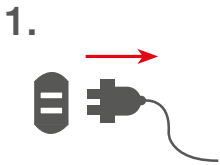
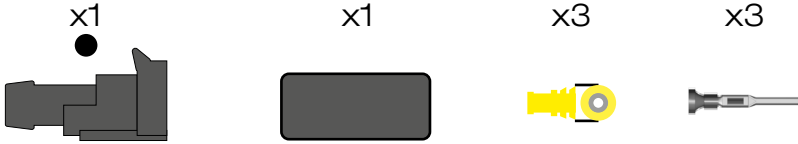

$I_{max}=14A$

# SuperSeal 4 pin female

SuperSeal  
4 pin

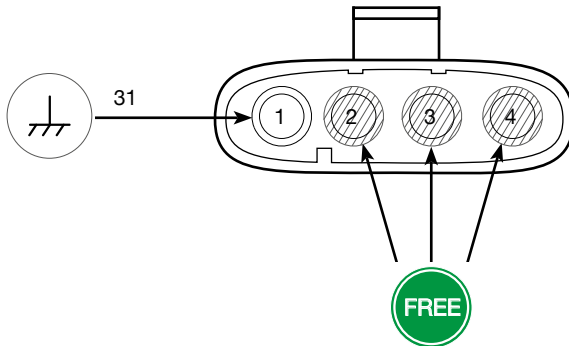
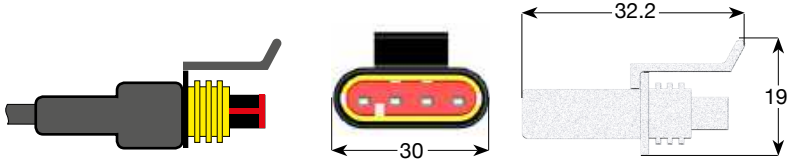

$I_{max}=14A$

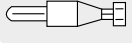



# Mounting instruction SuperSeal 4 pin female

SPARE PART NO.: 15-7002-084

SuperSeal  
4 pin

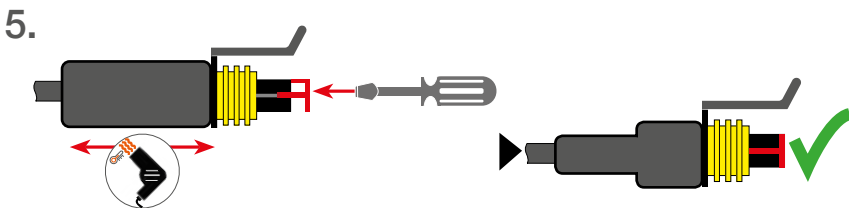
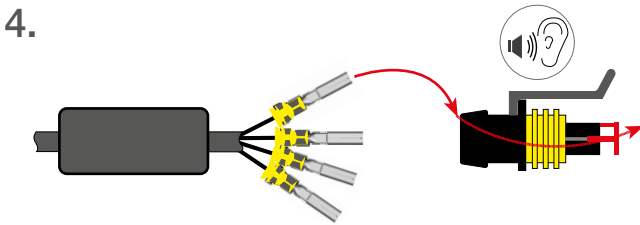
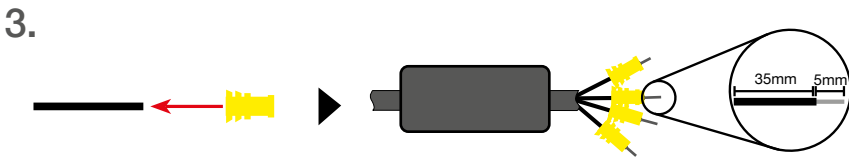
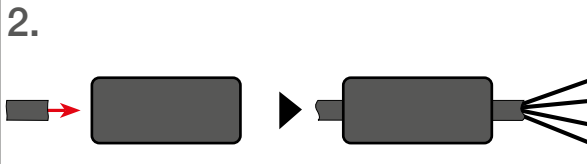
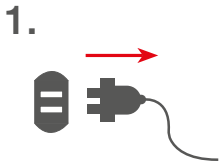
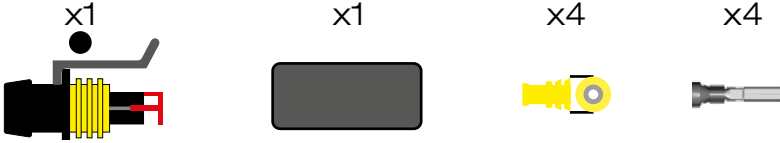

$I_{max}=14A$

# SuperSeal 4 pin male

SuperSeal  
4 pin

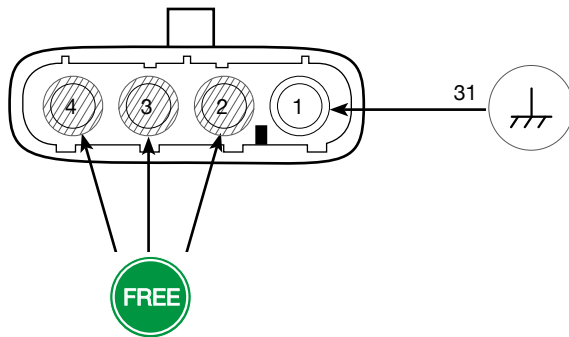
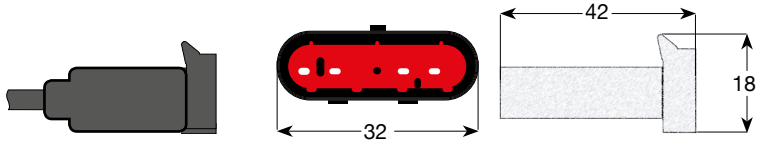

$I_{max}=14A$



# Mounting instruction SuperSeal 4 pin male

SuperSeal  
4 pin

SPARE PART NO.: 15-7002-094

x1

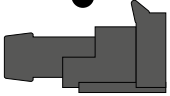

x1



x4



x4



1.

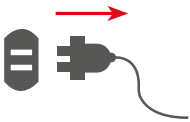

2.

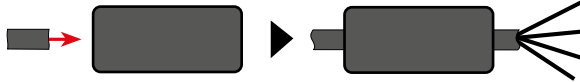

3.

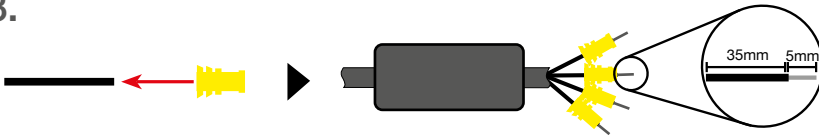

4.

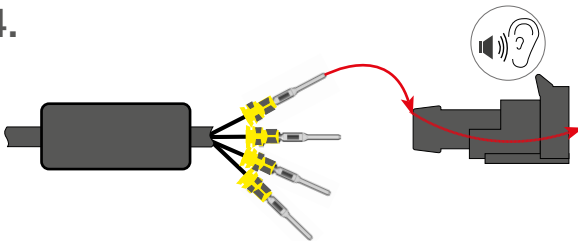

5.

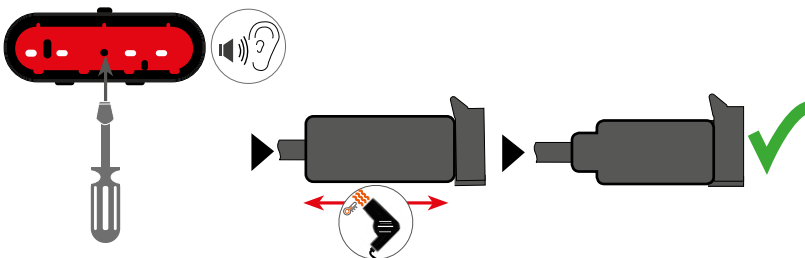

Imax=14A

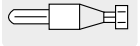

# SuperSeal 6 pin female

SuperSeal  
6 pin

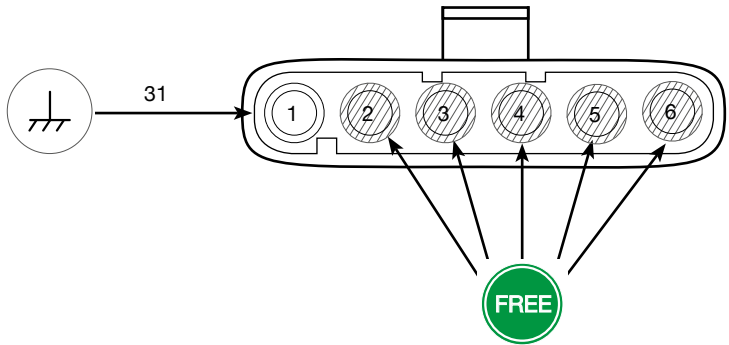
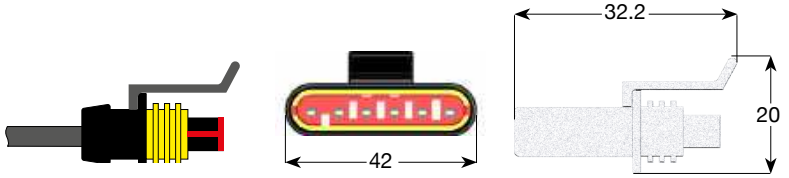

$I_{max}=14A$

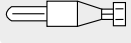

# Mounting instruction SuperSeal 6 pin female

SPARE PART NO.: 15-7002-104

SuperSeal  
6 pin

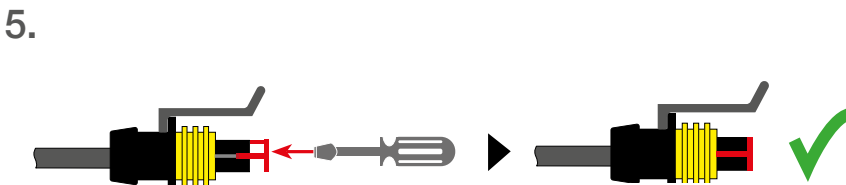
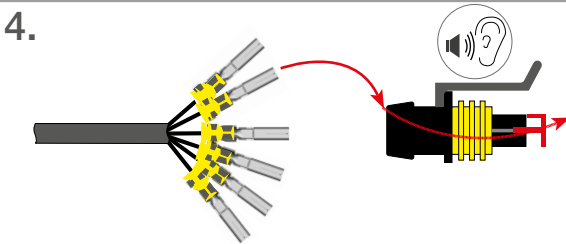
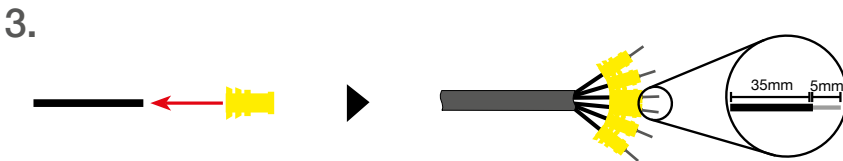
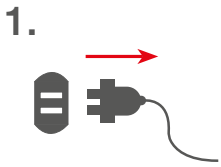
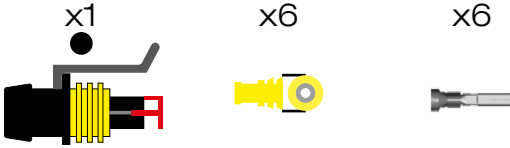

$I_{max}=14A$

# SuperSeal 6 pin male

SuperSeal  
6 pin

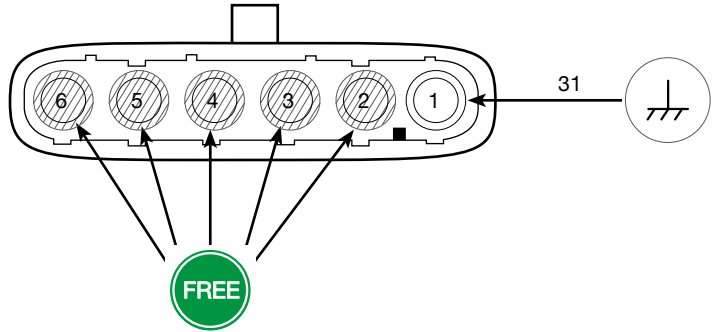
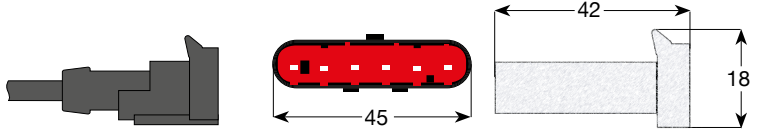

$I_{max}=14A$

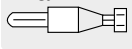

# Mounting instruction SuperSeal 6 pin male



SPARE PART NO.:15-7002-114

x1

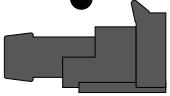

x6



x6



SuperSeal  
6 pin



1.

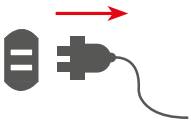

2.

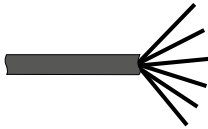

3.



4.

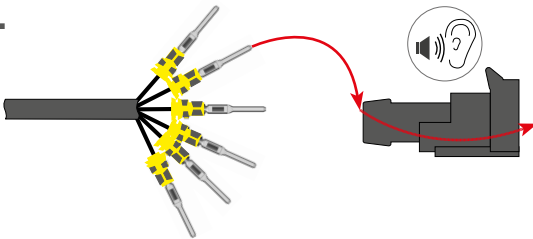

5.

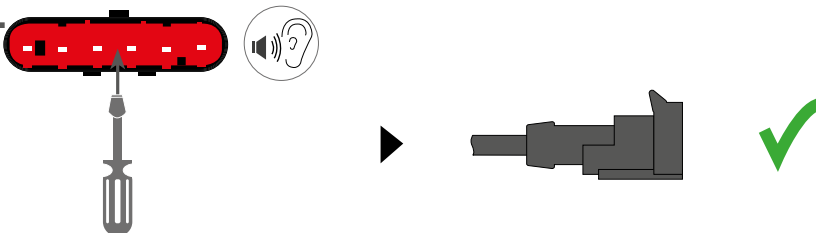

I<sub>max</sub>=14A

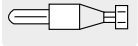

# DEUTSCH 2 pin female

DEUTSCH  
2 pin

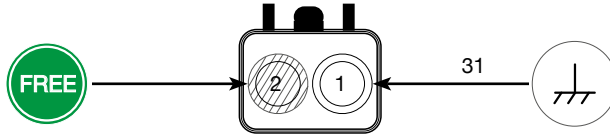
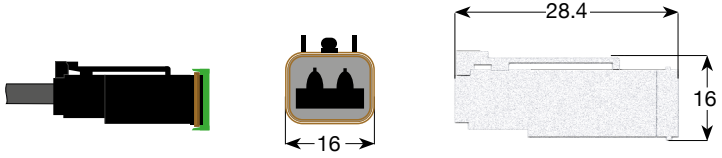

$I_{max}=13A$

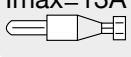



# Mounting instruction DEUTSCH 2 pin female

SPARE PART NO.: 15-7002-135

DEUTSCH  
2 pin

x1



x1



x2



1.

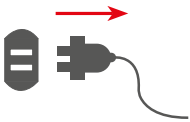

2.

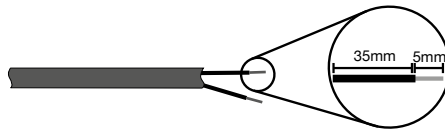

3.

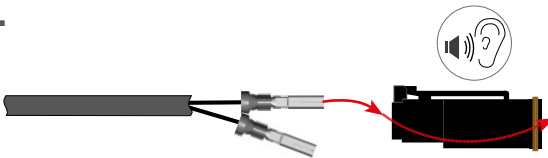

4.



5.



$I_{max}=13A$

# DEUTSCH 2 pin male

DEUTSCH  
2 pin

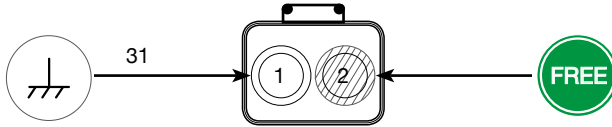
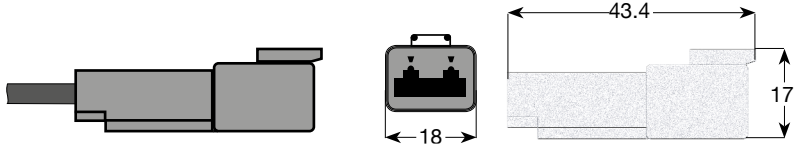

$I_{max}=13A$

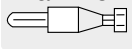

# Mounting instruction DEUTSCH 2 pin male

SPARE PART NO.: 15-7002-125

DEUTSCH  
2 pin

x1

x1

x2

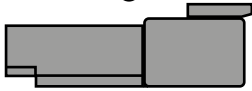

1.

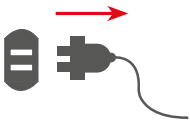

2.

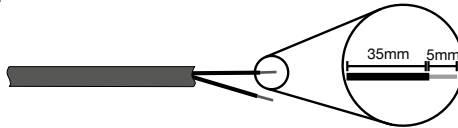

3.

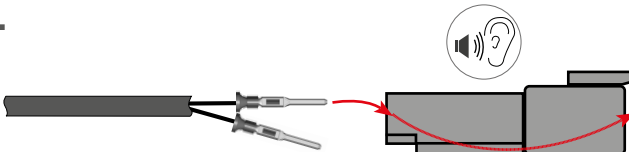

4.

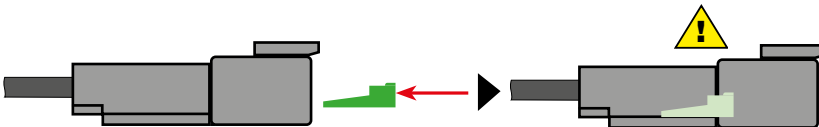

5.



$I_{max}=13A$

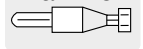

# DEUTSCH 4 pin female

DEUTSCH  
4 pin

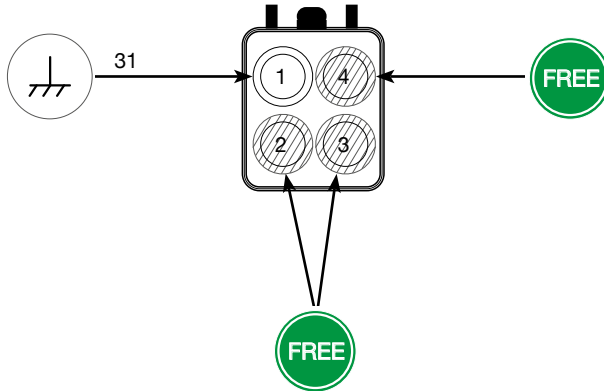
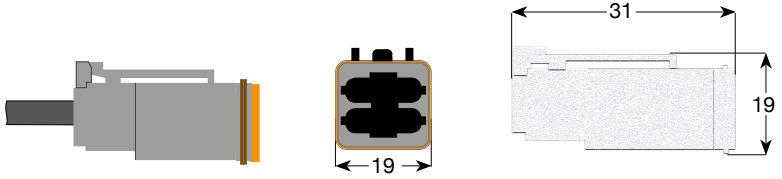

$I_{max}=13A$

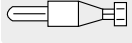

# Mounting instruction DEUTSCH 4 pin female

SPARE PART NO.: 15-7002-155

DEUTSCH  
4 pin

x1



x1



x4



1.

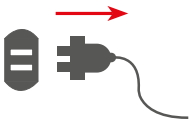

2.

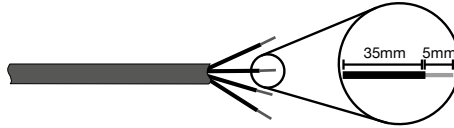

3.

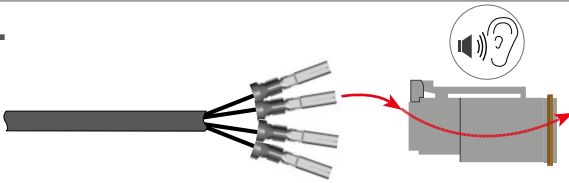

4.



5.

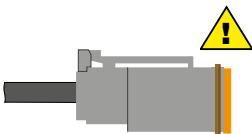

$I_{max}=13A$

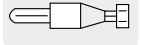

# DEUTSCH 4 pin male

DEUTSCH  
4 pin

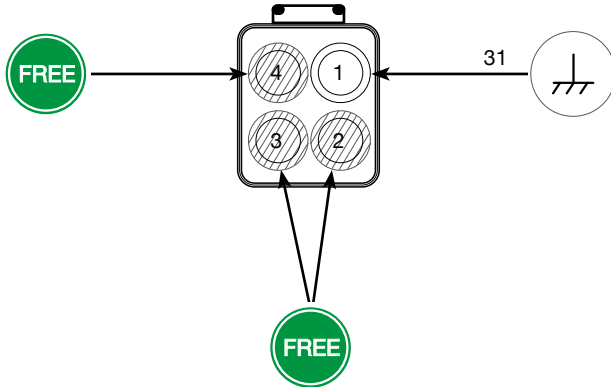
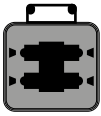
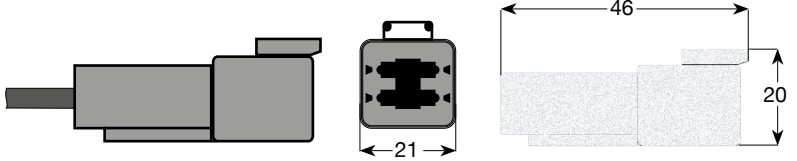

$I_{max}=13A$

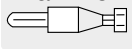

# Mounting instruction DEUTSCH 4 pin male

SPARE PART NO.: 15-7002-145

DEUTSCH  
4 pin

x1

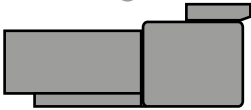

x1



x4



1.

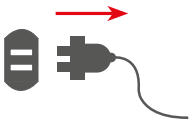

2.

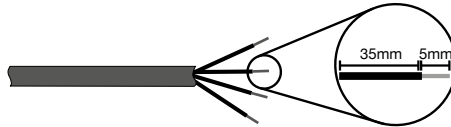

3.

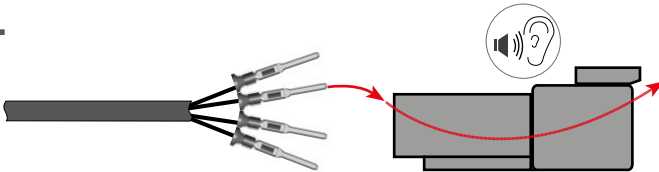

4.

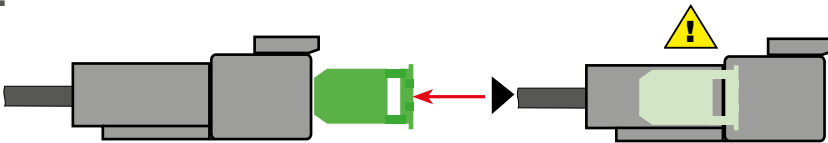

5.



$I_{max}=13A$

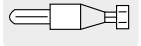

# DEUTSCH 6 pin female

DEUTSCH  
6 pin

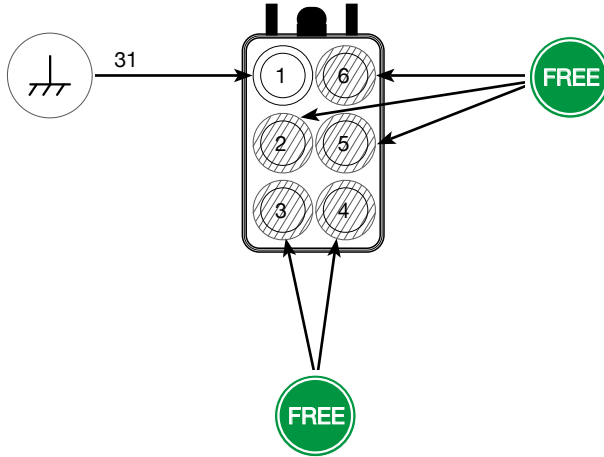
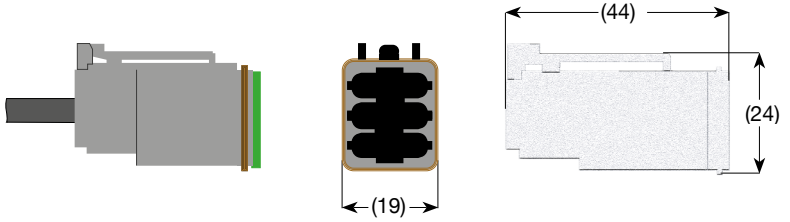

$I_{max}=13A$

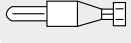



# Mounting instruction DEUTSCH 6 pin female

SPARE PART NO.: 15-7002-244

x1



x1



x6



DEUTSCH  
6 pin



1.

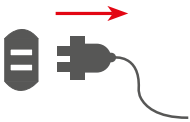

2.

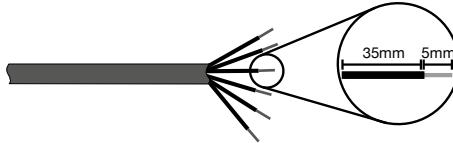

3.

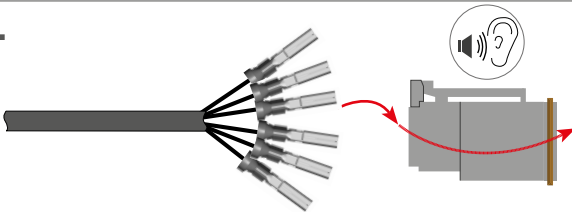

4.



5.

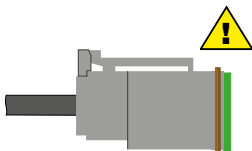

$I_{max}=13A$

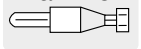

# Standard connector 3600 8 pin

3600  
8 pin

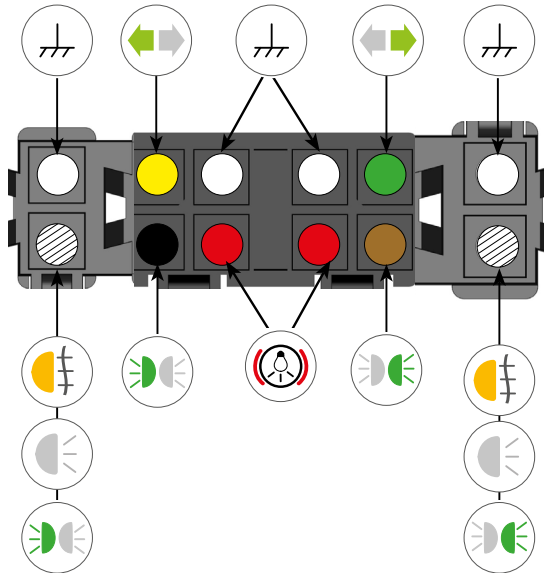
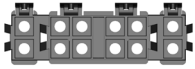
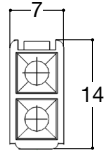
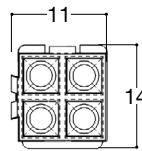
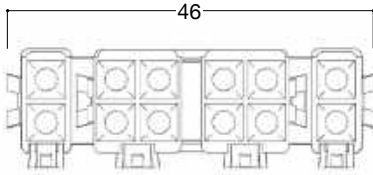
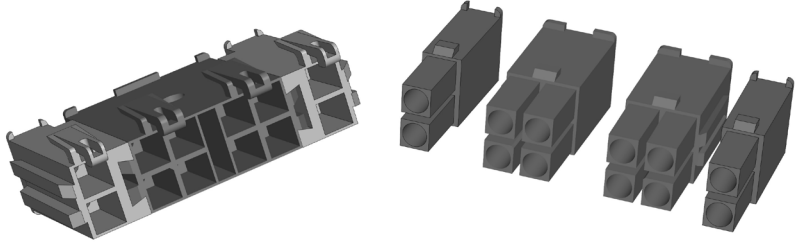
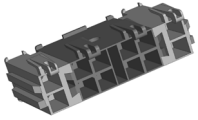

$I_{max}=16A$



# Standard connector 3612 12 pin

3612  
12 pin

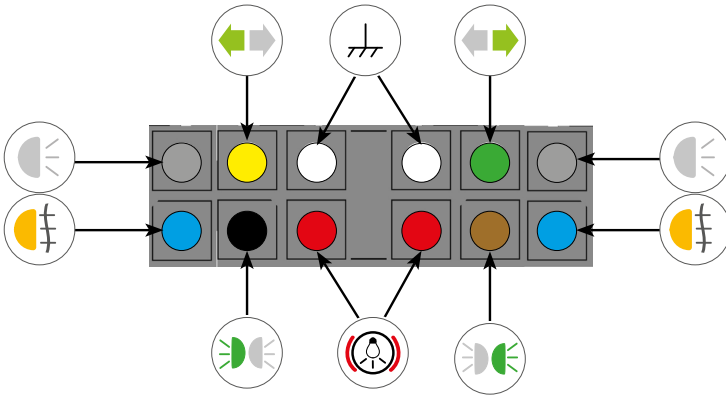
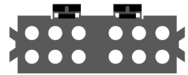
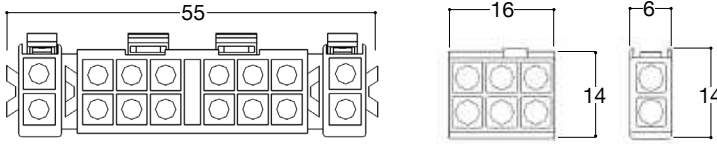
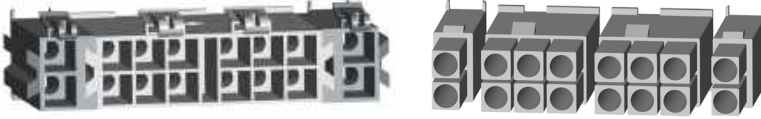

$I_{max}=16A$

# Caravan connector 3650 16 pin

3650  
16 pin

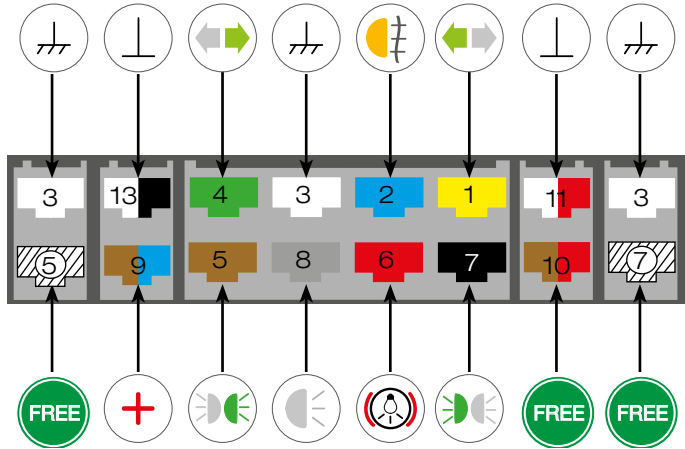
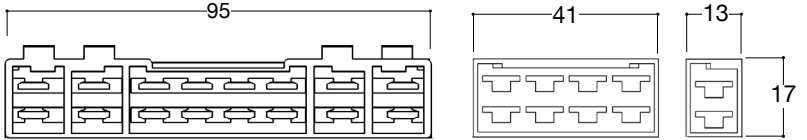

$I_{max}=25A$



# ISO 1185 7 pin, ISO 3731 7 pin



ISO 1185  
7 pin

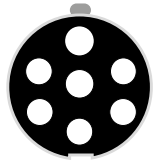
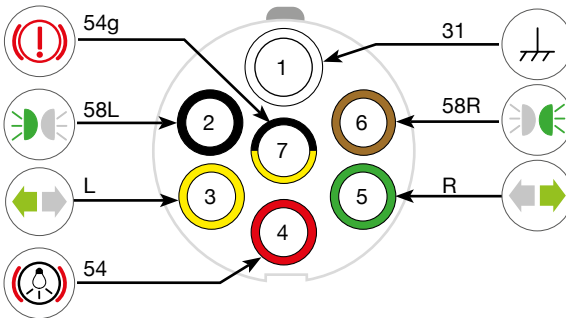

ISO 3731  
7 pin

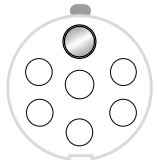
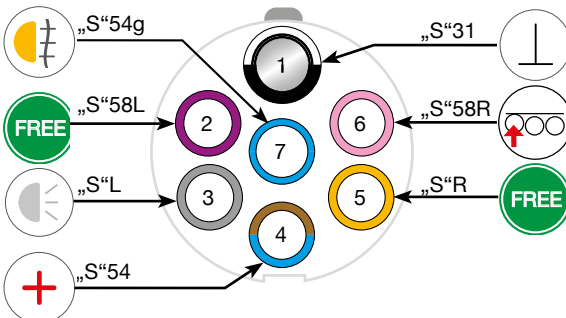

# ISO 12098 13 pin

ISO  
12098  
13 pin

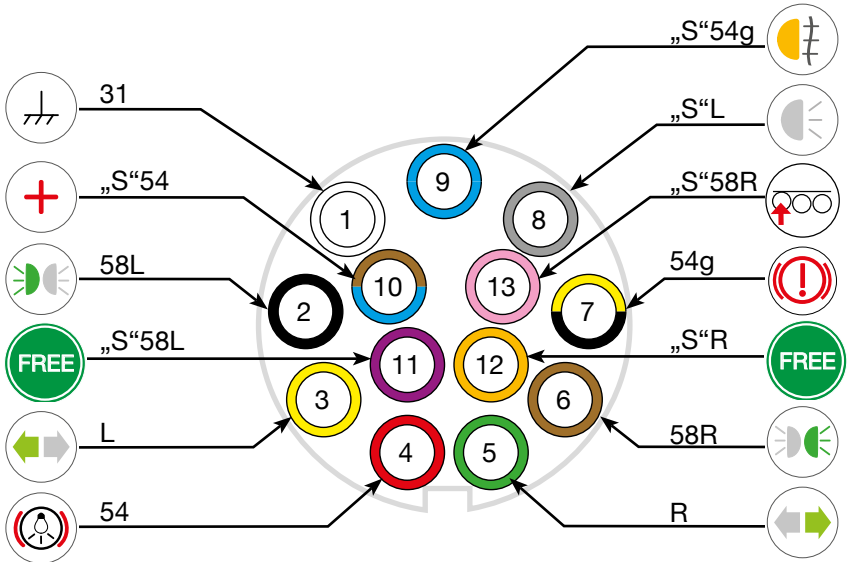
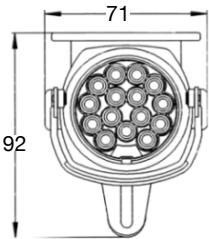

# ISO 12098 15 pin



ISO  
12098  
15 pin

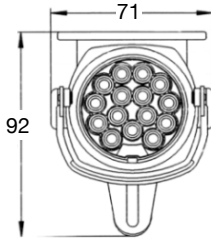
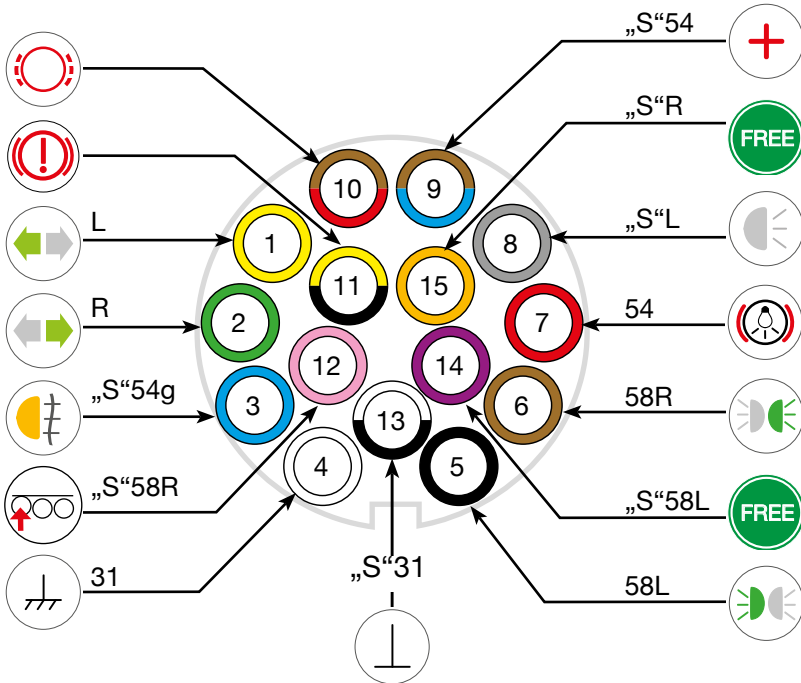

# ISO 1724 7 pin

ISO 1724  
7 pin

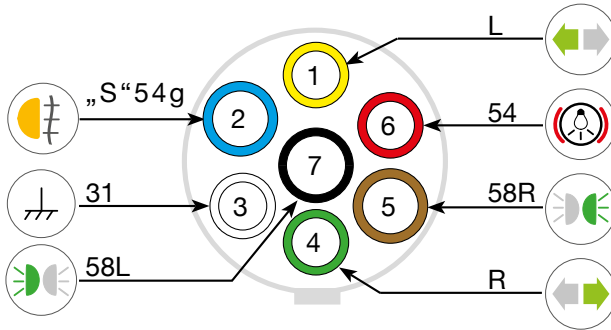



# ISO 11446 13 pin, ISO 11446 8 pin



ISO 11446  
13 pin

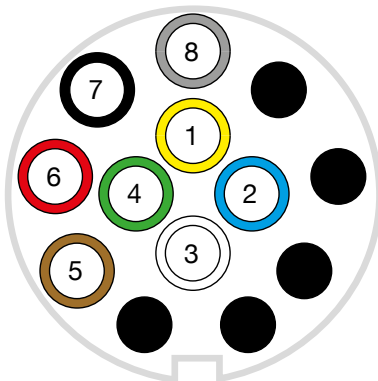
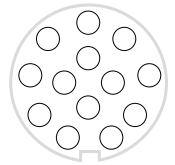
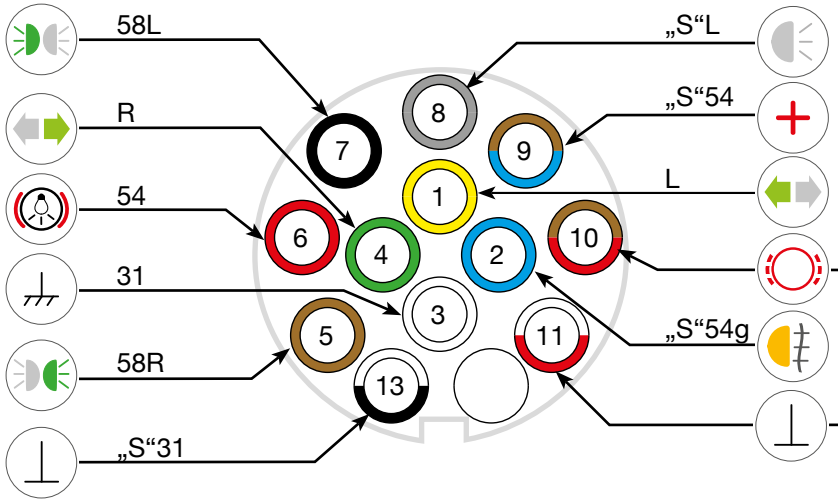

ISO 11446  
8 pin

DIN 9680  
3 pin

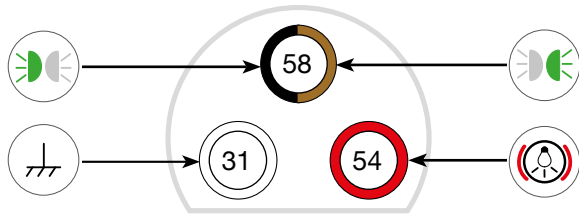
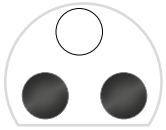

# VBG 14 pin



VBG  
14 pin

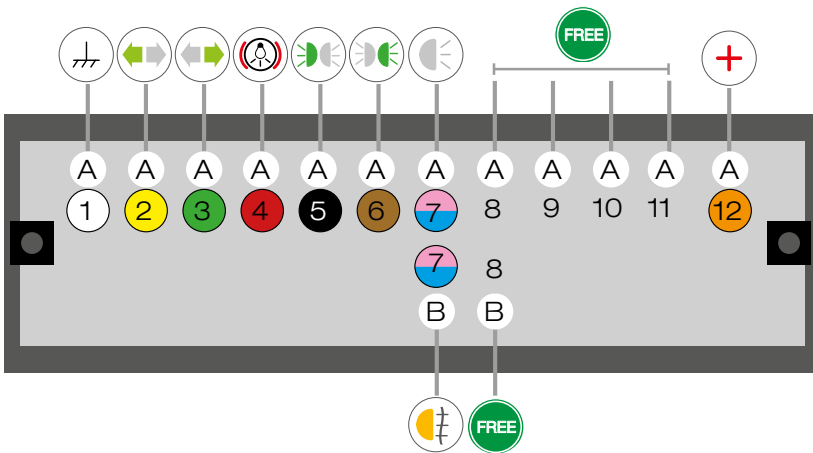

# THE ART OF LIGHTS

## ASPÖCK SYSTEMS GMBH

Enzing 4 | 4722 Peuerbach | AUSTRIA  
Phone: +43 72 76 / 26 70-0 | Fax: DW 1199  
E-Mail: office@aspoeck.com | www.aspoeck.com

Part N.: 10-0350-027  
Printing errors, technical changes,  
as well as picture changes reserved.  
Picture credits: All illustrations and photographs  
© Aspöck Systems GmbH 2020

MOUNTING SERVICE CONNECTORS  
BOOK SERVICE BOOK

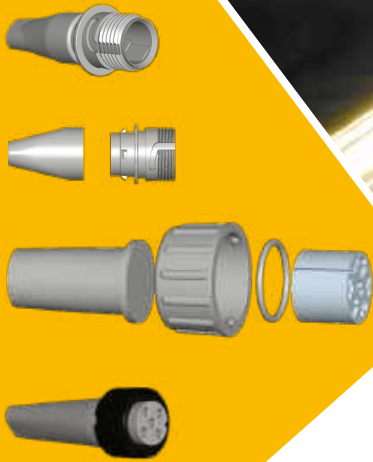

created: LAN    checked: TW    approved: BM    AAW 130.01  
Date: 22.02.2018    Date: 01.04.2020    Date: 01.04.2020    Version: 03